

filter Mec 316

OUR FILTERS

The cleaning filters **Mec 316** have been developed to guarantee perfect water filtration with high reliability and long life.

They are particularly suited to treatment of water rich in impurities, sand, rust and other extraneous substances.

It is equipped with discharge cock.

The filter Mec 316 is equipped with brass fittings that can rotate through 360° and can be easily mounted on vertical and horizontal pipes.

The filter Mec 316 guarantees a precise micrometric filtration for long periods by **means of stainless steel cartridge**.



OUR STRENGTHS

- Acetalic resin head, **TESTED ONE BY ONE** for a long lasting life
- It is suited to waters rich in impurities, sand rust and other extraneous substances.
- According to European norms.

TECHNICAL FEATURES

- Available with and without pressure reducer (from 1 to 6 bar)
- Brass fitting that can rotate through 360°
- **Stainless steel cartridge 89 microns**
- Transparent bowl in Trogamid
- Discharge cock
- PN 10

AVAILABLE VERSION



FILTER MEC 316 WITHOUT PRESSURE REDUCER

- PN 10
- Stainless steel cartridge 89 µm
- Discharge cock



FILTER MEC 316 WITH PRESSURE REDUCER

- Pressure reducer that can rotate through 360°
- PN 10
- Stainless steel cartridge 89 µm
- Discharge cock

TECHNICAL DATA

Model	Flow rate m³/h (0,2 bar)	Flow rate m³/h (0,5 bar)	PN bar	Pressure range	Fitting size	DN	Max H ₂ O Temp °C	Max Env. Temp °C	Weight kg	Front view	Side view	A mm	B mm	C mm	D mm	E mm
WITHOUT PRESSURE REDUCER																
MEC 316 - 3/4"	3,8	5,6	10	-	3/4"	20	40	40	2,1			298	251	110	172	118
MEC 316 - 1"	5,3	8,3	10	-	1"	25	40	40	2,0			298	251	110	183	122
MEC 316 - 1 1/4"	6,1	9,4	10	-	1 1/4"	32	40	40	2,1			298	251	110	188	122
WITH PRESSURE REDUCER																
MEC 316/R - 3/4"	-	2,3	10	1-6	3/4"	20	40	40	2,5			298	251	114	176	121
MEC 316/R - 1"	-	3,6	10	1-6	1"	25	40	40	2,6			298	251	114	187	121
MEC 316/R - 1 1/4"	-	5,8	10	1-6	1 1/4"	32	40	40	2,7			298	251	114	192	212

filter Mec 316

CLEANING AND REPLACING THE CARTRIDGE

To ensure effective operation, the filter cartridge must be cleaned periodically and replaced at least once a year.

SPARE PARTS

POS	DESCRIPTION	MEC 316 e 316 R 3/4"	MEC 316 e 316 R 1"	MEC 316 e 316 R 1 1/4"
1	Pressure reducer (only for 316 R)	FR250	FR250	FR250
2	Couple nuts, sockets and gaskets for R	FR211	FR023	FR025
1	Brass fitting	FR039	FR041	FR041
2	Couple nuts, sockets and gaskets	FR024	FR023	FR025
3	Head	FR045	FR045	FR045
4	Bowl + discharge cock	FR167	FR167	FR167
5	OR bowl/head	FR033	FR033	FR033
6	Square gasket	FR069	FR069	FR069
7	Stainless steel cartridge 50 µm	FR007	FR007	FR007
7	Stainless steel cartridge 89 µm	FR008	FR008	FR008
7	Stainless steel cartridge 200 µm	FR065	FR065	FR065
7	Stainless steel cartridge 500 µm	FR124	FR124	FR124
8	wrench	FR189	FR189	FR189

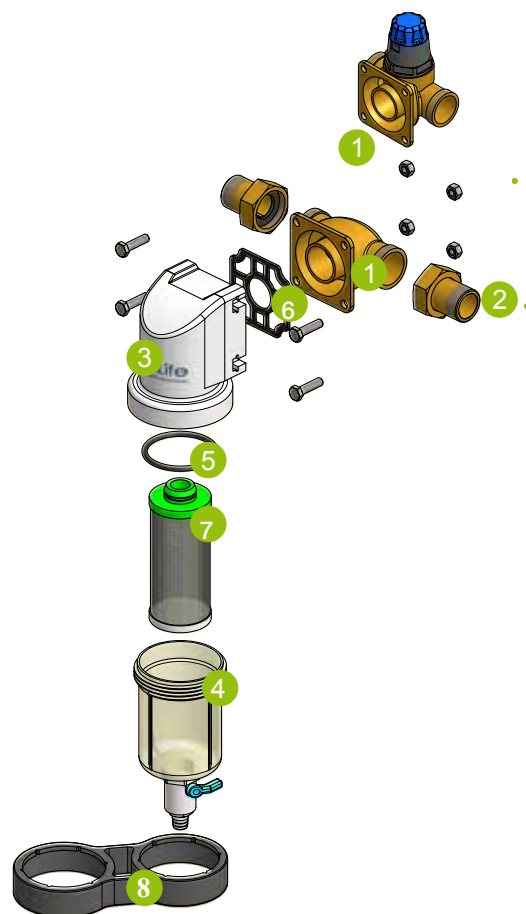

INSTALLATION SCHEME

