

Designations	Principal dimensions				Designations				
Adapter sleeve assembly					Adapter sleeve assembly	Included lock nut	Included locking device	Associated hydraulic nut	
	d1[mm]	d[mm]	d3[mm]	B1[mm]					
H 204	17	20	32	24	H 204	KM 4		MB 4	
H 304	17	20	32	28	H 304	KM 4		MB 4	
H 304 E	17	20	38	28	H 304 E		KMFE 4		
H 205	20	25	38	26	H 205	KM 5		MB 5	
H 305	20	25	38	29	H 305	KM 5		MB 5	
H 305 E	20	25	38	29	H 305 E		KMFE 5		
H 2305	20	25	38	35	H 2305	KM 5		MB 5	
H 206	25	30	45	27	H 206	KM 6		MB 6	
H 306	25	30	45	31	H 306	KM 6		MB 6	
H 306 E	25	30	45	31	H 306 E		KMFE 6		
H 2306	25	30	45	38	H 2306	KM 6		MB 6	
H 207	30	35	52	29	H 207	KM 7		MB 7	
H 307	30	35	52	35	H 307	KM 7		MB 7	
H 307 E	30	35	52	35	H 307 E		KMFE 7		
H 307 EL	30	35	52	35	H 307 EL		KMFE 7 L		
H 2307	30	35	52	43	H 2307	KM 7		MB 7	
H 208	35	40	58	31	H 208	KM 8		MB 8	
H 308	35	40	58	36	H 308	KM 8		MB 8	
H 308 E	35	40	58	36	H 308 E		KMFE 8		
H 2308	35	40	58	46	H 2308	KM 8		MB 8	
H 2308 E	35	40	58	46	H 2308 E		KMFE 8		
H 209	40	45	65	33	H 209	KM 9		MB 9	
H 309	40	45	65	39	H 309	KM 9		MB 9	
H 309 E	40	45	65	39	H 309 E		KMFE 9		
H 2309	40	45	65	50	H 2309	KM 9		MB 9	
H 210	45	50	70	35	H 210	KM 10		MB 10	H MV 10 E
H 310	45	50	70	42	H 310	KM 10		MB 10	H MV 10 E
H 310 E	45	50	70	42	H 310 E		KMFE 10		H MV 10 E
H 2310	45	50	70	55	H 2310	KM 10		MB 10	H MV 10 E
H 211	50	55	75	37	H 211	KM 11		MB 11	H MV 11 E
H 311	50	55	75	45	H 311	KM 11		MB 11	H MV 11 E
H 311 E	50	55	75	45	H 311 E		KMFE 11		H MV 11 E
H 2311	50	55	75	59	H 2311	KM 11		MB 11	H MV 11 E
H 212	55	60	80	38	H 212	KM 12		MB 12	H MV 12 E
H 312	55	60	80	47	H 312	KM 12		MB 12	H MV 12 E
H 312 E	55	60	80	47	H 312 E		KMFE 12		H MV 12 E
H 2312	55	60	80	62	H 2312	KM 12		MB 12	H MV 12 E

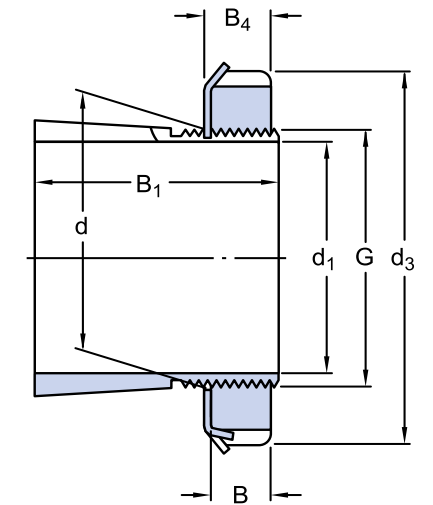

H 213	60	65	85	40	H 213	KM 13		MB 13		H MV 13 E
H 313	60	65	85	50	H 313	KM 13		MB 13		H MV 13 E
H 313 E	60	65	85	50	H 313 E		KMFE 13			H MV 13 E
H 2313	60	65	85	65	H 2313	KM 13		MB 13		H MV 13 E
H 2313 E	60	65	85	65	H 2313 E		KMFE 13			H MV 13 E
H 314	60	70	92	52	H 314	KM 14		MB 14		H MV 14 E
H 314 E	60	70	92	52	H 314 E		KMFE 14			H MV 14 E
H 2314	60	70	92	68	H 2314	KM 14		MB 14		H MV 14 E
H 215	65	75	98	43	H 215	KM 15		MB 15		H MV 15 E
H 315	65	75	98	55	H 315	KM 15		MB 15		H MV 15 E
H 315 E	65	75	98	55	H 315 E		KMFE 15			H MV 15 E
H 2315	65	75	98	73	H 2315	KM 15		MB 15		H MV 15 E
H 216	70	80	105	46	H 216	KM 16		MB 16		H MV 16 E
H 316	70	80	105	59	H 316	KM 16		MB 16		H MV 16 E
H 316 E	70	80	105	59	H 316 E		KMFE 16			H MV 16 E
H 2316	70	80	105	78	H 2316	KM 16		MB 16		H MV 16 E
H 217	75	85	110	50	H 217	KM 17		MB 17		H MV 17 E
H 317	75	85	110	63	H 317	KM 17		MB 17		H MV 17 E
H 317 E	75	85	110	63	H 317 E		KMFE 17			H MV 17 E
H 2317	75	85	110	82	H 2317	KM 17		MB 17		H MV 17 E
H 218	80	90	120	52	H 218	KM 18		MB 18		H MV 18 E
H 318	80	90	120	65	H 318	KM 18		MB 18		H MV 18 E
H 318 E	80	90	120	65	H 318 E		KMFE 18			H MV 18 E
H 2318 E/L73	80	90	120	73	H 2318 E/L73		KMFE 18			H MV 18 E
H 2318	80	90	120	86	H 2318	KM 18		MB 18		H MV 18 E
H 219	85	95	125	55	H 219	KM 19		MB 19		H MV 19 E
H 319	85	95	125	68	H 319	KM 19		MB 19		H MV 19 E
H 319 E	85	95	125	68	H 319 E		KMFE 19			H MV 19 E
H 2319	85	95	125	90	H 2319	KM 19		MB 19		H MV 19 E
H 2319 EL	85	95	125	90	H 2319 EL		KMFE 19 L			H MV 19 E
H 220	90	100	130	58	H 220	KM 20		MB 20		H MV 20 E
H 320	90	100	130	71	H 320	KM 20		MB 20		H MV 20 E
H 320 E	90	100	130	71	H 320 E		KMFE 20			H MV 20 E
H 3120	90	100	130	76	H 3120	KM 20		MB 20		H MV 20 E
H 3120 E	90	100	130	76	H 3120 E		KMFE 20			H MV 20 E
H 2320	90	100	130	97	H 2320	KM 20		MB 20		H MV 20 E
H 2320 E	90	100	130	97	H 2320 E		KMFE 20			H MV 20 E
H 222	100	110	145	63	H 222	KM 22		MB 22		H MV 22 E
H 322	100	110	145	77	H 322	KM 22		MB 22		H MV 22 E
H 322 E	100	110	145	77	H 322 E		KMFE 22			H MV 22 E
H 3122	100	110	145	81	H 3122	KM 22		MB 22		H MV 22 E
H 3122 E	100	110	145	81	H 3122 E		KMFE 22			H MV 22 E
H 2322	100	110	145	105	H 2322	KM 22		MB 22		H MV 22 E
H 2322 E	100	110	145	105	H 2322 E		KMFE 22			H MV 22 E
H 3024	110	120	145	72	H 3024	KML 24		MBL 24		H MV 24 E
H 3124 L	110	120	145	88	H 3124 L	KML 24		MBL 24		H MV 24 E
H 2324 L	110	120	145	112	H 2324 L		KML 24		MBL 24	H MV 24 E
H 3024 E	110	120	155	72	H 3024 E		KMFE 24			H MV 24 E
H 3124	110	120	155	88	H 3124	KM 24		MB 24		H MV 24 E
H 2324	110	120	155	112	H 2324	KM 24		MB 24		H MV 24 E
H 2324 E	110	120	155	112	H 2324 E		KMFE 24			H MV 24 E
H 2324 EH	110	120	155	112	H 2324 EH		KMFE 24 H			H MV 24 E
H 3026	115	130	155	80	H 3026	KML 26		MBL 26		H MV 26 E

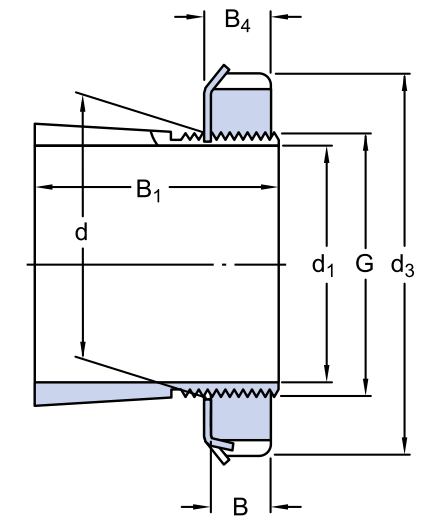

OH 3148 HTL	220	240	290	172	OH 3148 HTL	HM 3048	MS 3052-48	HME 3052	MS 3052-48	HME 3052	HMV 48E
OH 3148 H	220	240	300	172	OH 3148 H	HM 48 T	MB 48	MS 3052-48	MS 3052-48	HME 3052	HMV 48E
OH 2348 H	220	240	300	199	OH 2348 H	HM 48 T	MB 48	MS 3052-48	MS 3052-48	HME 3052	HMV 48E
OH 3952 H	240	260	310	116	OH 3952 H	HM 3052	MS 3052-48	MS 3052-48	MS 3052-48	HME 3052	HMV 52E
OH 3052 H	240	260	310	145	OH 3052 H	HM 3052	MS 3052-48	MS 3052-48	MS 3052-48	HME 3052	HMV 52E
OH 3052 HE	240	260	310	145	OH 3052 HE	HME 3052	MS 3052-48	MS 3052-48	MS 3052-48	HME 3052	HMV 52E
OH 3152 HTL	240	260	310	190	OH 3152 HTL	HM 3052	MS 3052-48	MS 3052-48	MS 3052-48	HME 3052	HMV 52E
OH 3152 H	240	260	330	190	OH 3152 H	HM 52 T	MB 52	MS 3052-48	MS 3052-48	HME 3052	HMV 52E
OH 2352 H	240	260	330	211	OH 2352 H	HM 52 T	MB 52	MS 3052-48	MS 3052-48	HME 3052	HMV 52E
OH 3956 H	260	280	330	121	OH 3956 H	HM 3056	MS 3056	MS 3056	MS 3056	HME 3056	HMV 56E
OH 3056 H	260	280	330	152	OH 3056 H	HM 3056	MS 3056	MS 3056	MS 3056	HME 3056	HMV 56E
OH 3156 HTL	260	280	330	195	OH 3156 HTL	HM 3056	MS 3056	MS 3056	MS 3056	HME 3056	HMV 56E
OH 3156 H	260	280	350	195	OH 3156 H	HM 56 T	MB 56	MS 3056	MS 3056	HME 3056	HMV 56E
OH 2356 H	260	280	350	224	OH 2356 H	HM 56 T	MB 56	MS 3056	MS 3056	HME 3056	HMV 56E
OH 3960 H	280	300	360	140	OH 3960 H	HM 3060	MS 3060	MS 3060	MS 3060	HME 3060	HMV 60E
OH 3060 H	280	300	360	168	OH 3060 H	HM 3060	MS 3060	MS 3060	MS 3060	HME 3060	HMV 60E
OH 3160 H	280	300	380	208	OH 3160 H	HM 3160	MS 3160	MS 3160	MS 3160	HME 3160	HMV 60E
OH 3160 HE	280	300	380	208	OH 3160 HE	HME 3160	MS 3160	MS 3160	MS 3160	HME 3160	HMV 60E
OH 3260 H	280	300	380	240	OH 3260 H	HM 3160	MS 3160	MS 3160	MS 3160	HME 3160	HMV 60E
OH 3964 H	300	320	380	140	OH 3964 H	HM 3064	MS 3068-64	MS 3068-64	MS 3068-64	HME 3068	HMV 64E
OH 3064 H	300	320	380	171	OH 3064 H	HM 3064	MS 3068-64	MS 3068-64	MS 3068-64	HME 3068	HMV 64E
OH 3164 H	300	320	400	226	OH 3164 H	HM 3164	MS 3164	MS 3164	MS 3164	HME 3164	HMV 64E
OH 3264 H	300	320	400	258	OH 3264 H	HM 3164	MS 3164	MS 3164	MS 3164	HME 3164	HMV 64E
OH 3968 H	320	340	400	144	OH 3968 H	HM 3068	MS 3068-64	MS 3068-64	MS 3068-64	HME 3068	HMV 68E
OH 3068 H	320	340	400	187	OH 3068 H	HM 3068	MS 3068-64	MS 3068-64	MS 3068-64	HME 3068	HMV 68E
OH 3168 H	320	340	440	254	OH 3168 H	HM 3168	MS 3172-68	MS 3172-68	MS 3172-68	HME 3172	HMV 68E
OH 3168 HE	320	340	440	254	OH 3168 HE	HME 3168	MS 3172-68	MS 3172-68	MS 3172-68	HME 3172	HMV 68E
OH 3268 H	320	340	440	288	OH 3268 H	HM 3168	MS 3172-68	MS 3172-68	MS 3172-68	HME 3172	HMV 68E
OH 3972 H	340	360	420	144	OH 3972 H	HM 3072	MS 3072	MS 3072	MS 3072	HME 3072	HMV 72E
OH 3972 HE	340	360	420	144	OH 3972 HE	HME 3072	MS 3072	MS 3072	MS 3072	HME 3072	HMV 72E
OH 3072 H	340	360	420	188	OH 3072 H	HM 3072	MS 3072	MS 3072	MS 3072	HME 3072	HMV 72E
OH 3172 H	340	360	460	259	OH 3172 H	HM 3172	MS 3172-68	MS 3172-68	MS 3172-68	HME 3172	HMV 72E
OH 3172 HE	340	360	460	259	OH 3172 HE	HME 3172	MS 3172-68	MS 3172-68	MS 3172-68	HME 3172	HMV 72E
OH 3272 H	340	360	460	299	OH 3272 H	HM 3172	MS 3172-68	MS 3172-68	MS 3172-68	HME 3172	HMV 72E
OH 3976 H	360	380	450	164	OH 3976 H	HM 3076	MS 3080-76	MS 3080-76	MS 3080-76	HME 3080	HMV 76E
OH 3976 HE	360	380	450	164	OH 3976 HE	HME 3076	MS 3080-76	MS 3080-76	MS 3080-76	HME 3080	HMV 76E
OH 3076 H	360	380	450	193	OH 3076 H	HM 3076	MS 3080-76	MS 3080-76	MS 3080-76	HME 3080	HMV 76E
OH 3176 H	360	380	490	264	OH 3176 H	HM 3176	MS 3176	MS 3176	MS 3176	HME 3176	HMV 76E
OH 3176 HE	360	380	490	264	OH 3176 HE	HME 3176	MS 3176	MS 3176	MS 3176	HME 3176	HMV 76E
OH 3276 H	360	380	490	310	OH 3276 H	HM 3176	MS 3176	MS 3176	MS 3176	HME 3176	HMV 76E
OH 3980 H	380	400	470	168	OH 3980 H	HM 3080	MS 3080-76	MS 3080-76	MS 3080-76	HME 3080	HMV 80E
OH 3980 HE	380	400	470	168	OH 3980 HE	HME 3080	MS 3080-76	MS 3080-76	MS 3080-76	HME 3080	HMV 80E
OH 3080 H	380	400	470	210	OH 3080 H	HM 3080	MS 3080-76	MS 3080-76	MS 3080-76	HME 3080	HMV 80E
OH 3180 H	380	400	520	272	OH 3180 H	HM 3180	MS 3184-80	MS 3184-80	MS 3184-80	HME 3184	HMV 80E
OH 3180 HE	380	400	520	272	OH 3180 HE	HME 3180	MS 3184-80	MS 3184-80	MS 3184-80	HME 3184	HMV 80E
OH 3280 H	380	400	520	328	OH 3280 H	HM 3180	MS 3184-80	MS 3184-80	MS 3184-80	HME 3184	HMV 80E
OH 3984 H	400	420	490	168	OH 3984 H	HM 3084	MS 3084	MS 3084	MS 3084	HME 3084	HMV 84E
OH 3984 HE	400	420	490	168	OH 3984 HE	HME 3084	MS 3084	MS 3084	MS 3084	HME 3084	HMV 84E
OH 3084 H	400	420	490	212	OH 3084 H	HM 3084	MS 3084	MS 3084	MS 3084	HME 3084	HMV 84E
OH 3184 H	400	420	540	304	OH 3184 H	HM 3184	MS 3184-80	MS 3184-80	MS 3184-80	HME 3184	HMV 84E
OH 3284 H	400	420	540	352	OH 3284 H	HM 3184	MS 3184-80	MS 3184-80	MS 3184-80	HME 3184	HMV 84E
OH 3988 H	410	440	520	189	OH 3988 H	HM 3088	MS 3092-88	MS 3092-88	MS 3092-88	HME 3092	HMV 88E
OH 3988 HE	410	440	520	189	OH 3988 HE	HME 3088	MS 3092-88	MS 3092-88	MS 3092-88	HME 3092	HMV 88E

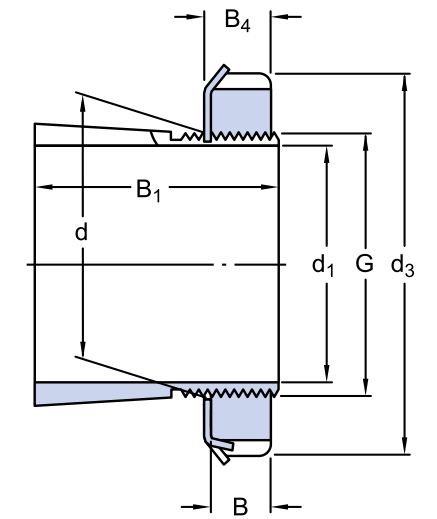

OH 3088 H	410	440	520	228	OH 3088 H	HM 3088	MS 3092-88	HME 3088	MS 3092-88	HME 3088
OH 3088 HE	410	440	520	228	OH 3088 HE	HME 3088	MS 3092-88	MS 3092-88	MS 3092-88	HME 3088
OH 3188 H	410	440	560	307	OH 3188 H	HM 3188	MS 3192-88	MS 3192-88	MS 3192-88	HM 3188
OH 3188 HE	410	440	560	307	OH 3188 HE	HME 3188	MS 3192-88	MS 3192-88	MS 3192-88	HME 3188
OH 3288 H	410	440	560	361	OH 3288 H	HM 3188	MS 3192-88	MS 3192-88	MS 3192-88	HM 3188
OH 3992 H	430	460	540	189	OH 3992 H	HM 3092	MS 3092-88	MS 3092-88	MS 3092-88	HM 3092
OH 3092 H	430	460	540	234	OH 3092 H	HM 3092	MS 3092-88	MS 3092-88	MS 3092-88	HM 3092
OH 3192 H	430	460	580	326	OH 3192 H	HM 3192	MS 3192-88	MS 3192-88	MS 3192-88	HM 3192
OH 3292 H	430	460	580	382	OH 3292 H	HM 3192	MS 3192-88	MS 3192-88	MS 3192-88	HM 3192
OH 3996 H	450	480	560	200	OH 3996 H	HM 3096	MS 30/500-96	MS 30/500-96	MS 30/500-96	HM 3096
OH 3996 HE	450	480	560	200	OH 3996 HE	HME 3096	MS 30/500-96	MS 30/500-96	MS 30/500-96	HME 3096
OH 3096 H	450	480	560	237	OH 3096 H	HM 3096	MS 30/500-96	MS 30/500-96	MS 30/500-96	HM 3096
OH 3196 H	450	480	620	335	OH 3196 H	HM 3196	MS 3196	MS 3196	MS 3196	HM 3196
OH 3196 HE	450	480	620	335	OH 3196 HE	HME 3196	MS 3196	MS 3196	MS 3196	HME 3196
OH 3296 H	450	480	620	397	OH 3296 H	HM 3196	MS 3196	MS 3196	MS 3196	HM 3196
OH 39/500 H	470	500	580	208	OH 39/500 H	HM 30/500	MS 30/500-96	MS 30/500-96	MS 30/500-96	HM 30/500
OH 39/500 HE	470	500	580	208	OH 39/500 HE	HME 30/500	MS 30/500-96	MS 30/500-96	MS 30/500-96	HME 30/500
OH 30/500 H	470	500	580	247	OH 30/500 H	HM 30/500	MS 30/500-96	MS 30/500-96	MS 30/500-96	HM 30/500
OH 31/500 H	470	500	630	356	OH 31/500 H	HM 31/500	MS 31/500	MS 31/500	MS 31/500	HM 31/500
OH 32/500 H	470	500	630	428	OH 32/500 H	HM 31/500	MS 31/500	MS 31/500	MS 31/500	HM 31/500
OH 39/530 HE	500	530	630	216	OH 39/530 HE	HME 30/530	MS 30/600-530	MS 30/600-530	MS 30/600-530	HME 30/530
OH 30/530 H	500	530	630	265	OH 30/530 H	HM 30/530	MS 30/600-530	MS 30/600-530	MS 30/600-530	HM 30/530
OH 31/530 H	500	530	670	364	OH 31/530 H	HM 31/530	MS 31/530	MS 31/530	MS 31/530	HM 31/530
OH 32/530 H	500	530	670	447	OH 32/530 H	HM 31/530	MS 31/530	MS 31/530	MS 31/530	HM 31/530
OH 39/560 H	530	560	650	227	OH 39/560 H	HM 30/560	MS 30/560	MS 30/560	MS 30/560	HM 30/560
OH 39/560 HE	530	560	650	227	OH 39/560 HE	HME 30/560	MS 30/560	MS 30/560	MS 30/560	HME 30/560
OH 30/560 H	530	560	650	282	OH 30/560 H	HM 30/560	MS 30/560	MS 30/560	MS 30/560	HM 30/560
OH 31/560 H	530	560	710	377	OH 31/560 H	HM 31/560	MS 31/600-560	MS 31/600-560	MS 31/600-560	HM 31/560
OH 31/560 HE	530	560	710	377	OH 31/560 HE	HME 31/560	MS 31/600-560	MS 31/600-560	MS 31/600-560	HME 31/560
OH 32/560 H	530	560	710	462	OH 32/560 H	HM 31/560	MS 31/600-560	MS 31/600-560	MS 31/600-560	HM 31/560
OH 31/600 HE	530	600	750	377	OH 31/600 HE	HME 31/600	MS 31/600-560	MS 31/600-560	MS 31/600-560	HME 31/600
OH 39/600 H	560	600	700	239	OH 39/600 H	HM 30/600	MS 30/600-530	MS 30/600-530	MS 30/600-530	HM 30/600
OH 39/600 HE	560	600	700	239	OH 39/600 HE	HME 30/600	MS 30/600-530	MS 30/600-530	MS 30/600-530	HME 30/600
OH 30/600 H	560	600	700	289	OH 30/600 H	HM 30/600	MS 30/600-530	MS 30/600-530	MS 30/600-530	HM 30/600
OH 31/600 H	560	600	750	399	OH 31/600 H	HM 31/600	MS 31/600-560	MS 31/600-560	MS 31/600-560	HM 31/600
OH 32/600 H	560	600	750	487	OH 32/600 H	HM 31/600	MS 31/600-560	MS 31/600-560	MS 31/600-560	HM 31/600
OH 39/630 H	600	630	730	254	OH 39/630 H	HM 30/630	MS 30/630	MS 30/630	MS 30/630	HM 30/630
OH 39/630 HE	600	630	730	254	OH 39/630 HE	HME 30/630	MS 30/630	MS 30/630	MS 30/630	HME 30/630
OH 30/630 H	600	630	730	301	OH 30/630 H	HM 30/630	MS 30/630	MS 30/630	MS 30/630	HM 30/630
OH 31/630 H	600	630	800	424	OH 31/630 H	HM 31/630	MS 31/630	MS 31/630	MS 31/630	HM 31/630
OH 31/630 HE	600	630	800	424	OH 31/630 HE	HME 31/630	MS 31/630	MS 31/630	MS 31/630	HME 31/630
OH 30/670 H	630	670	780	324	OH 30/670 H	HM 30/670	MS 30/670	MS 30/670	MS 30/670	HM 30/670
OH 31/670 H	630	670	850	456	OH 31/670 H	HM 31/670	MS 31/670	MS 31/670	MS 31/670	HM 31/670
OH 31/670 HE	630	670	850	456	OH 31/670 HE	HME 31/670	MS 31/670	MS 31/670	MS 31/670	HME 31/670
OH 32/670 H	630	670	850	558	OH 32/670 H	HM 31/670	MS 31/670	MS 31/670	MS 31/670	HM 31/670
OH 39/710 H	670	710	830	286	OH 39/710 H	HM 30/710	MS 30/710	MS 30/710	MS 30/710	HM 30/710
OH 39/710 HE	670	710	830	286	OH 39/710 HE	HME 30/710	MS 30/710	MS 30/710	MS 30/710	HME 30/710
OH 30/710 H	670	710	830	342	OH 30/710 H	HM 30/710	MS 30/710	MS 30/710	MS 30/710	HM 30/710
OH 30/710 HE	670	710	830	342	OH 30/710 HE	HME 30/710	MS 30/710	MS 30/710	MS 30/710	HME 30/710
OH 31/710 H	670	710	900	467	OH 31/710 H	HM 31/710	MS 31/710	MS 31/710	MS 31/710	HM 31/710
OH 31/710 HE	670	710	900	467	OH 31/710 HE	HME 31/710	MS 31/710	MS 31/710	MS 31/710	HME 31/710
OH 32/710 H	670	710	900	572	OH 32/710 H	HM 31/710	MS 31/710	MS 31/710	MS 31/710	HM 31/710
OH 39/750 H	710	750	870	291	OH 39/750 H	HM 30/750	MS 30/800-750	MS 30/800-750	MS 30/800-750	HM 30/750

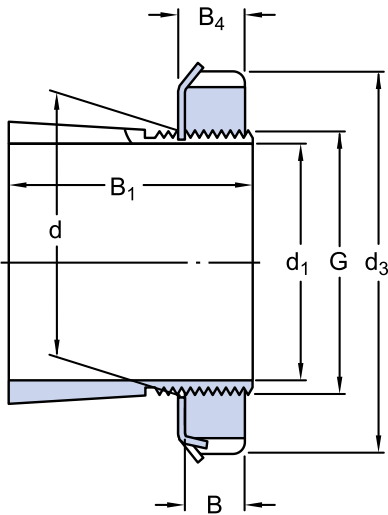

OH 39/750 HE	710	750	870	291	OH 39/750 HE	HME 30/750	MS 30/800-750	HMV 150E
OH 30/750 H	710	750	870	356	OH 30/750 H	HM 30/750	MS 30/800-750	HMV 150E
OH 30/750 HE	710	750	870	356	OH 30/750 HE	HME 30/750	MS 30/800-750	HMV 150E
OH 31/750 H	710	750	950	493	OH 31/750 H	HM 31/750	MS 31/800-750	HMV 150E
OH 31/750 HE	710	750	950	493	OH 31/750 HE	HME 31/750	MS 31/800-750	HMV 150E
OH 32/750 H	710	750	950	603	OH 32/750 H	HM 31/750	MS 31/800-750	HMV 150E
OH 39/800 H	750	800	920	303	OH 39/800 H	HM 30/800	MS 30/800-750	HMV 160E
OH 39/800 HE	750	800	920	303	OH 39/800 HE	HME 30/800	MS 30/800-750	HMV 160E
OH 30/800 H	750	800	920	366	OH 30/800 H	HM 30/800	MS 30/800-750	HMV 160E
OH 30/800 HE	750	800	920	366	OH 30/800 HE	HME 30/800	MS 30/800-750	HMV 160E
OH 31/800 H	750	800	1 000	505	OH 31/800 H	HM 31/800	MS 31/800-750	HMV 160E
OH 31/800 HE	750	800	1 000	505	OH 31/800 HE	HME 31/800	MS 31/800-750	HMV 160E
OH 39/850 H	800	850	980	308	OH 39/850 H	HM 30/850	MS 30/900-850	HMV 170E
OH 39/850 HE	800	850	980	308	OH 39/850 HE	HME 30/850	MS 30/900-850	HMV 170E
OH 30/850 H	800	850	980	380	OH 30/850 H	HM 30/850	MS 30/900-850	HMV 170E
OH 30/850 HE	800	850	980	380	OH 30/850 HE	HME 30/850	MS 30/900-850	HMV 170E
OH 31/850 H	800	850	1 060	536	OH 31/850 H	HM 31/850	MS 31/850	HMV 170E
OH 31/850 HE	800	850	1 060	536	OH 31/850 HE	HME 31/850	MS 31/850	HMV 170E
OH 39/900 H	850	900	1 030	326	OH 39/900 H	HM 30/900	MS 30/900-850	HMV 180E
OH 39/900 HE	850	900	1 030	326	OH 39/900 HE	HME 30/900	MS 30/900-850	HMV 180E
OH 30/900 H	850	900	1 030	400	OH 30/900 H	HM 30/900	MS 30/900-850	HMV 180E
OH 30/900 HE	850	900	1 030	400	OH 30/900 HE	HME 30/900	MS 30/900-850	HMV 180E
OH 31/900 H	850	900	1 120	557	OH 31/900 H	HM 31/900	MS 31/900	HMV 180E
OH 39/950 H	900	950	1 080	344	OH 39/950 H	HM 30/950	MS 30/950	HMV 190E
OH 39/950 HE	900	950	1 080	344	OH 39/950 HE	HME 30/950	MS 30/950	HMV 190E
OH 30/950 H	900	950	1 080	420	OH 30/950 H	HM 30/950	MS 30/950	HMV 190E
OH 30/950 HE	900	950	1 080	420	OH 30/950 HE	HME 30/950	MS 30/950	HMV 190E
OH 31/950 H	900	950	1 170	583	OH 31/950 H	HM 31/950	MS 31/950	HMV 190E
OH 39/1000 H	950	1 000	1 140	358	OH 39/1000 H	HM 30/1000	MS 30/1000	HMV 200E
OH 30/1000 H	950	1 000	1 140	430	OH 30/1000 H	HM 30/1000	MS 30/1000	HMV 200E
OH 30/1000 HE	950	1 000	1 140	430	OH 30/1000 HE	HME 30/1000	MS 30/1000	HMV 200E
OH 31/1000 H	950	1 000	1 240	609	OH 31/1000 H	HM 31/1000	MS 31/1000	HMV 200E
OH 31/1000 HE	950	1 000	1 240	609	OH 31/1000 HE	HME 31/1000	MS 31/1000	HMV 200E
OH 39/1060 H	1 000	1 060	1 200	372	OH 39/1060 H	HM 30/1060	MS 30/1000	HMV 212E
OH 39/1060 HE	1 000	1 060	1 200	372	OH 39/1060 HE	HME 30/1060	MS 30/1000	HMV 212E
OH 30/1060 H	1 000	1 060	1 200	447	OH 30/1060 H	HM 30/1060	MS 30/1000	HMV 212E
OH 31/1060 H	1 000	1 060	1 300	622	OH 31/1060 H	HM 31/1060	MS 31/1000	HMV 212E

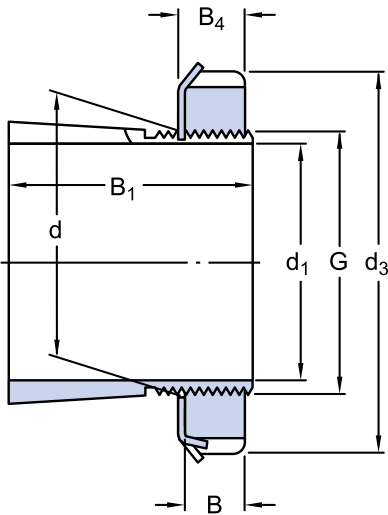

Designations	Principal dimensions				Designations			
Adapter sleeve assembly					Adapter sleeve assembly	Included lock nut	Included locking device	Associated hydraulic nut
	d1[mm]	d[mm]	d3[mm]	B1[mm]				
HE 205	19.05	25	38	26	HE 205	KM 5	MB 5	
HE 305	19.05	25	38	29	HE 305	KM 5	MB 5	
HE 305 E	19.05	25	38	29	HE 305 E	KMFE 5		
HE 2305	19.05	25	38	35	HE 2305	KM 5	MB 5	
HA 206	23.813	30	45	27	HA 206	KM 6	MB 6	
HA 306	23.813	30	45	31	HA 306	KM 6	MB 6	
HA 306 E	23.813	30	45	31	HA 306 E	KMFE 6		
HA 2306	23.813	30	45	38	HA 2306	KM 6	MB 6	
HE 206	25.4	30	45	27	HE 206	KM 6	MB 6	
HE 306	25.4	30	45	31	HE 306	KM 6	MB 6	
HE 306 E	25.4	30	45	31	HE 306 E	KMFE 6		
HE 2306	25.4	30	45	38	HE 2306	KM 6	MB 6	
HA 207	30.163	35	52	29	HA 207	KM 7	MB 7	
HA 307	30.163	35	52	35	HA 307	KM 7	MB 7	
HA 307 E	30.163	35	52	35	HA 307 E	KMFE 7		
HA 307 EL	30.163	35	52	35	HA 307 EL	KMFE 7 L		
HA 2307	30.163	35	52	43	HA 2307	KM 7	MB 7	
HE 208	31.75	40	58	31	HE 208	KM 8	MB 8	
HE 308	31.75	40	58	36	HE 308	KM 8	MB 8	
HE 308 E	31.75	40	58	36	HE 308 E	KMFE 8		
HE 2308	31.75	40	58	46	HE 2308	KM 8	MB 8	
HE 2308 E	31.75	40	58	46	HE 2308 E	KMFE 8		
HA 209	36.513	45	65	33	HA 209	KM 9	MB 9	
HA 309	36.513	45	65	39	HA 309	KM 9	MB 9	
HA 309 E	36.513	45	65	39	HA 309 E	KMFE 9		
HA 2309	36.513	45	65	50	HA 2309	KM 9	MB 9	
HE 209	38.1	45	65	33	HE 209	KM 9	MB 9	
HE 309	38.1	45	65	39	HE 309	KM 9	MB 9	
HE 309 E	38.1	45	65	39	HE 309 E	KMFE 9		
HE 2309	38.1	45	65	50	HE 2309	KM 9	MB 9	
HA 210	42.863	50	70	35	HA 210	KM 10	MB 10	H MV 10 E
HA 310	42.863	50	70	42	HA 310	KM 10	MB 10	H MV 10 E
HA 310 E	42.863	50	70	42	HA 310 E	KMFE 10		H MV 10 E
HA 2310	42.863	50	70	55	HA 2310	KM 10	MB 10	H MV 10 E

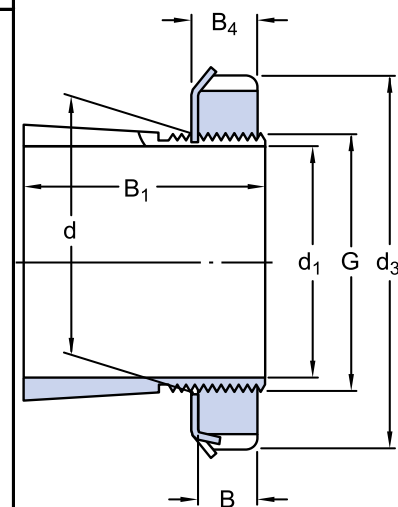

HE 210	44.45	50	70	35	HE 210	KM 10	MB 10	H MV 10 E
HE 310	44.45	50	70	42	HE 310	KM 10	MB 10	H MV 10 E
HE 310 E	44.45	50	70	42	HE 310 E	KMFE 10		H MV 10 E
HE 2310	44.45	50	70	55	HE 2310	KM 10	MB 10	H MV 10 E
HA 211	49.213	55	75	37	HA 211	KM 11	MB 11	H MV 11 E
HA 311	49.213	55	75	45	HA 311	KM 11	MB 11	H MV 11 E
HA 311 E	49.213	55	75	45	HA 311 E	KMFE 11		H MV 11 E
HA 2311	49.213	55	75	59	HA 2311	KM 11	MB 11	H MV 11 E
HE 211 B	50.8	55	75	37	HE 211 B	HM 11	MB 11	
HE 311 B	50.8	55	75	45	HE 311 B	HM 11	MB 11	
HE 311 BE	50.8	55	75	45	HE 311 BE	KMFE 11 B		
HE 2311 B	50.8	55	75	59	HE 2311 B	HM 11	MB 11	
HA 213	55.563	65	85	40	HA 213	KM 13	MB 13	H MV 13 E
HA 313	55.563	65	85	50	HA 313	KM 13	MB 13	H MV 13 E
HA 313 E	55.563	65	85	50	HA 313 E	KMFE 13		H MV 13 E
HA 2313	55.563	65	85	65	HA 2313	KM 13	MB 13	H MV 13 E
HA 2313 E	55.563	65	85	65	HA 2313 E	KMFE 13		H MV 13 E
HE 213	57.15	65	85	40	HE 213	KM 13	MB 13	H MV 13 E
HE 313	57.15	65	85	50	HE 313	KM 13	MB 13	H MV 13 E
HE 313 E	57.15	65	85	50	HE 313 E	KMFE 13		H MV 13 E
HE 2313	57.15	65	85	65	HE 2313	KM 13	MB 13	H MV 13 E
HE 2313 E	57.15	65	85	65	HE 2313 E	KMFE 13		H MV 13 E
HA 215	61.913	75	98	43	HA 215	KM 15	MB 15	H MV 15 E
HA 315	61.913	75	98	55	HA 315	KM 15	MB 15	H MV 15 E
HA 315 E	61.913	75	98	55	HA 315 E	KMFE 15		H MV 15 E
HA 2315	61.913	75	98	73	HA 2315	KM 15	MB 15	H MV 15 E
HE 215	63.5	75	98	43	HE 215	KM 15	MB 15	H MV 15 E
HE 315	63.5	75	98	55	HE 315	KM 15	MB 15	H MV 15 E
HE 315 E	63.5	75	98	55	HE 315 E	KMFE 15		H MV 15 E
HE 2315	63.5	75	98	73	HE 2315	KM 15	MB 15	H MV 15 E
HA 216	68.263	80	105	46	HA 216	KM 16	MB 16	H MV 16 E
HA 316	68.263	80	105	59	HA 316	KM 16	MB 16	H MV 16 E
HA 316 E	68.263	80	105	59	HA 316 E	KMFE 16		H MV 16 E
HA 2316	68.263	80	105	78	HA 2316	KM 16	MB 16	H MV 16 E
HE 216	69.85	80	105	46	HE 216	KM 16	MB 16	H MV 16 E
HE 316	69.85	80	105	59	HE 316	KM 16	MB 16	H MV 16 E
HE 316 E	69.85	80	105	59	HE 316 E	KMFE 16		H MV 16 E
HE 2316	69.85	80	105	78	HE 2316	KM 16	MB 16	H MV 16 E
HA 217	74.613	85	110	50	HA 217	KM 17	MB 17	H MV 17 E
HA 317	74.613	85	110	63	HA 317	KM 17	MB 17	H MV 17 E
HA 317 E	74.613	85	110	63	HA 317 E	KMFE 17		H MV 17 E
HA 2317	74.613	85	110	82	HA 2317	KM 17	MB 17	H MV 17 E
HE 217	76.2	85	110	50	HE 217	KM 17	MB 17	H MV 17 E
HE 317	76.2	85	110	63	HE 317	KM 17	MB 17	H MV 17 E
HE 317 E	76.2	85	110	63	HE 317 E	KMFE 17		H MV 17 E
HE 2317	76.2	85	110	82	HE 2317	KM 17	MB 17	H MV 17 E
HA 218	80.963	90	120	52	HA 218	KM 18	MB 18	H MV 18 E
HA 318	80.963	90	120	65	HA 318	KM 18	MB 18	H MV 18 E
HA 318 E	80.963	90	120	65	HA 318 E	KMFE 18		H MV 18 E
HA 2318 E/L73	80.963	90	120	73	HA 2318 E/L73	KMFE 18		H MV 18 E
HA 2318	80.963	90	120	86	HA 2318	KM 18	MB 18	H MV 18 E
HE 218	82.55	90	120	52	HE 218	KM 18	MB 18	H MV 18 E

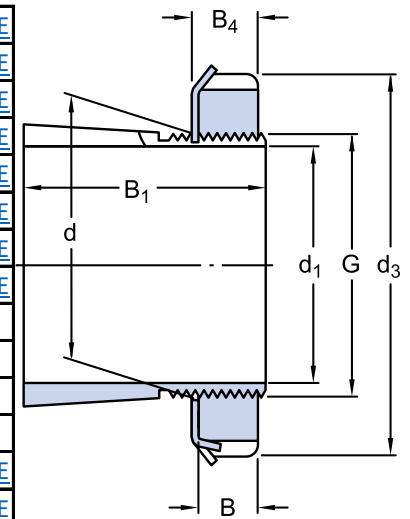

HE 318	82.55	90	120	65	HE 318	KM 18	MB 18	H MV 18 E
HE 318 E	82.55	90	120	65	HE 318 E	KMFE 18		H MV 18 E
HE 2318 E/L73	82.55	90	120	73	HE 2318 E/L73	KMFE 18		H MV 18 E
HE 2318	82.55	90	120	86	HE 2318	KM 18	MB 18	H MV 18 E
HE 219	82.55	95	125	55	HE 219	KM 19	MB 19	H MV 19 E
HE 319	82.55	95	125	68	HE 319	KM 19	MB 19	H MV 19 E
HE 319 E	82.55	95	125	68	HE 319 E	KMFE 19		H MV 19 E
HE 2319	82.55	95	125	90	HE 2319	KM 19	MB 19	H MV 19 E
HE 2319 EL	82.55	95	125	90	HE 2319 EL	KMFE 19 L		H MV 19 E
HA 220	87.313	100	130	58	HA 220	KM 20	MB 20	H MV 20 E
HA 320	87.313	100	130	71	HA 320	KM 20	MB 20	H MV 20 E
HA 320 E	87.313	100	130	71	HA 320 E	KMFE 20		H MV 20 E
HA 2320	87.313	100	130	97	HA 2320	KM 20	MB 20	H MV 20 E
HA 2320 E	87.313	100	130	97	HA 2320 E	KMFE 20		H MV 20 E
HE 220	88.9	100	130	58	HE 220	KM 20	MB 20	H MV 20 E
HE 320	88.9	100	130	71	HE 320	KM 20	MB 20	H MV 20 E
HE 320 E	88.9	100	130	71	HE 320 E	KMFE 20		H MV 20 E
HE 3120	88.9	100	130	76	HE 3120	KM 20	MB 20	H MV 20 E
HE 3120 E	88.9	100	130	76	HE 3120 E	KMFE 20		H MV 20 E
HE 2320	88.9	100	130	97	HE 2320	KM 20	MB 20	H MV 20 E
HE 2320 E	88.9	100	130	97	HE 2320 E	KMFE 20		H MV 20 E
HE 222	101.6	110	145	63	HE 222	KM 22	MB 22	H MV 22 E
HE 322	101.6	110	145	77	HE 322	KM 22	MB 22	H MV 22 E
HE 322 E	101.6	110	145	77	HE 322 E	KMFE 22		H MV 22 E
HE 3122	101.6	110	145	81	HE 3122	KM 22	MB 22	H MV 22 E
HE 3122 E	101.6	110	145	81	HE 3122 E	KMFE 22		H MV 22 E
HE 2322	101.6	110	145	105	HE 2322	KM 22	MB 22	H MV 22 E
HE 2322 E	101.6	110	145	105	HE 2322 E	KMFE 22		H MV 22 E
HA 3024	106.363	120	145	72	HA 3024	KML 24	MBL 24	H MV 24 E
HA 3124 L	106.363	120	145	88	HA 3124 L	KML 24	MBL 24	H MV 24 E
HA 2324 L	106.363	120	145	112	HA 2324 L	KML 24	MBL 24	H MV 24 E
HA 3024 E	106.363	120	155	72	HA 3024 E	KMFE 24		H MV 24 E
HA 3124	106.363	120	155	88	HA 3124	KM 24	MB 24	H MV 24 E
HA 2324	106.363	120	155	112	HA 2324	KM 24	MB 24	H MV 24 E
HA 2324 E	106.363	120	155	112	HA 2324 E	KMFE 24		H MV 24 E
HA 2324 EH	106.363	120	155	112	HA 2324 EH	KMFE 24 H		H MV 24 E
HE 3024	107.95	120	145	72	HE 3024	KML 24	MBL 24	H MV 24 E
HE 2324 L	107.95	120	145	112	HE 2324 L	KML 24	MBL 24	H MV 24 E
HE 3024 E	107.95	120	155	72	HE 3024 E	KMFE 24		H MV 24 E
HE 3124	107.95	120	155	88	HE 3124	KM 24	MB 24	H MV 24 E
HE 2324	107.95	120	155	112	HE 2324	KM 24	MB 24	H MV 24 E
HE 2324 E	107.95	120	155	112	HE 2324 E	KMFE 24		H MV 24 E
HE 2324 EH	107.95	120	155	112	HE 2324 EH	KMFE 24 H		H MV 24 E
HA 3026	112.713	130	155	80	HA 3026	KML 26	MBL 26	H MV 26 E
HA 3126 L	112.713	130	155	92	HA 3126 L	KML 26	MBL 26	H MV 26 E
HA 2326 L	112.713	130	155	121	HA 2326 L	KML 26	MBL 26	H MV 26 E
HA 3026 E	112.713	130	165	80	HA 3026 E	KMFE 26		H MV 26 E
HA 3126	112.713	130	165	92	HA 3126	KM 26	MB 26	H MV 26 E
HA 3126 E	112.713	130	165	92	HA 3126 E	KMFE 26		H MV 26 E
HA 2326	112.713	130	165	121	HA 2326	KM 26	MB 26	H MV 26 E
HE 3026	114.3	130	155	80	HE 3026	KML 26	MBL 26	H MV 26 E
HE 3126 L	114.3	130	155	92	HE 3126 L	KML 26	MBL 26	H MV 26 E

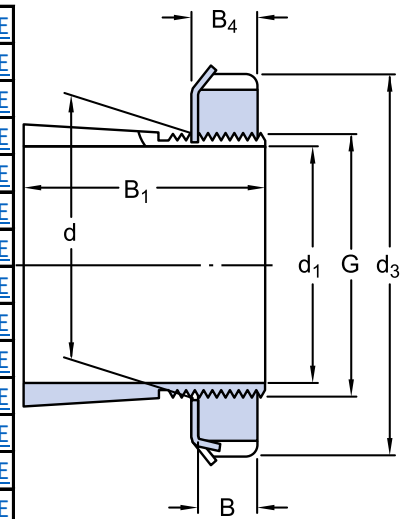

HE 2326 L	114.3	130	155	121	HE 2326 L	KML 26	MBL 26	HML 26 E
HE 3026 E	114.3	130	165	80	HE 3026 E	KMFE 26		HML 26 E
HE 3126	114.3	130	165	92	HE 3126	KM 26	MB 26	HML 26 E
HE 2326	114.3	130	165	121	HE 2326	KM 26	MB 26	HML 26 E
HA 3028	125.413	140	165	82	HA 3028	KML 28	MBL 28	HML 28 E
HA 3128 L	125.413	140	165	97	HA 3128 L	KML 28	MBL 28	HML 28 E
HA 3028 E	125.413	140	180	82	HA 3028 E	KMFE 28		HML 28 E
HA 3128	125.413	140	180	97	HA 3128	KM 28	MB 28	HML 28 E
HA 2328	125.413	140	180	131	HA 2328	KM 28	MB 28	HML 28 E
HE 3028	127	140	165	82	HE 3028	KML 28	MBL 28	HML 28 E
HE 3128 L	127	140	165	97	HE 3128 L	KML 28	MBL 28	HML 28 E
HE 3028 E	127	140	180	82	HE 3028 E	KMFE 28		HML 28 E
HE 3128	127	140	180	97	HE 3128	KM 28	MB 28	HML 28 E
HE 2328	127	140	180	131	HE 2328	KM 28	MB 28	HML 28 E
HA 3030	131.763	150	180	87	HA 3030	KML 30	MBL 30	HML 30 E
HA 3130 L	131.763	150	180	111	HA 3130 L	KML 30	MBL 30	HML 30 E
HA 2330 L	131.763	150	180	139	HA 2330 L	KML 30	MBL 30	HML 30 E
HA 3030 E	131.763	150	195	87	HA 3030 E	KMFE 30		HML 30 E
HA 3130	131.763	150	195	111	HA 3130	KM 30	MB 30	HML 30 E
HA 3130 E	131.763	150	195	111	HA 3130 E	KMFE 30		HML 30 E
HA 2330	131.763	150	195	139	HA 2330	KM 30	MB 30	HML 30 E
HE 3030	133.35	150	180	87	HE 3030	KML 30	MBL 30	HML 30 E
HE 3130 L	133.35	150	180	111	HE 3130 L	KML 30	MBL 30	HML 30 E
HE 2330 L	133.35	150	180	139	HE 2330 L	KML 30	MBL 30	HML 30 E
HE 3030 E	133.35	150	195	111	HE 3030 E	KMFE 30		HML 30 E
HE 3130	133.35	150	195	111	HE 3130	KM 30	MB 30	HML 30 E
HE 3130 E	133.35	150	195	111	HE 3130 E	KMFE 30		HML 30 E
HE 2330	133.35	150	195	139	HE 2330	KM 30	MB 30	HML 30 E
HA 3032	138.113	160	190	93	HA 3032	KML 32	MBL 32	HML 32 E
HA 3132 L	138.113	160	190	119	HA 3132 L	KML 32	MBL 32	HML 32 E
HA 2332 L	138.113	160	190	147	HA 2332 L	KML 32	MBL 32	HML 32 E
HA 3032 E	138.113	160	210	93	HA 3032 E	KMFE 32		HML 32 E
HA 3132	138.113	160	210	119	HA 3132	KM 32	MB 32	HML 32 E
HA 3132 E	138.113	160	210	119	HA 3132 E	KMFE 32		HML 32 E
HA 2332	138.113	160	210	147	HA 2332	KM 32	MB 32	HML 32 E
HE 3032	139.7	160	190	93	HE 3032	KML 32	MBL 32	HML 32 E
HE 3132 L	139.7	160	190	119	HE 3132 L	KML 32	MBL 32	HML 32 E
HE 2332 L	139.7	160	190	147	HE 2332 L	KML 32	MBL 32	HML 32 E
HE 3032 E	139.7	160	210	93	HE 3032 E	KMFE 32		HML 32 E
HE 3132	139.7	160	210	119	HE 3132	KM 32	MB 32	HML 32 E
HE 3132 E	139.7	160	210	119	HE 3132 E	KMFE 32		HML 32 E
HE 2332	139.7	160	210	147	HE 2332	KM 32	MB 32	HML 32 E
HA 3034	150.813	170	200	101	HA 3034	KML 34	MBL 34	HML 34 E
HA 3134 L	150.813	170	200	122	HA 3134 L	KML 34	MBL 34	HML 34 E
HA 3034 E	150.813	170	220	101	HA 3034 E	KMFE 34		HML 34 E
HA 3134	150.813	170	220	122	HA 3134	KM 34	MB 34	HML 34 E
HA 3134 E	150.813	170	220	122	HA 3134 E	KMFE 34		HML 34 E
HA 2334	150.813	170	220	154	HA 2334	KM 34	MB 34	HML 34 E
HE 3034	152.4	170	200	101	HE 3034	KML 34	MBL 34	HML 34 E
HE 3134 L	152.4	170	200	122	HE 3134 L	KML 34	MBL 34	HML 34 E
HE 3034 E	152.4	170	220	101	HE 3034 E	KMFE 34		HML 34 E
HE 3134	152.4	170	220	122	HE 3134	KM 34	MB 34	HML 34 E

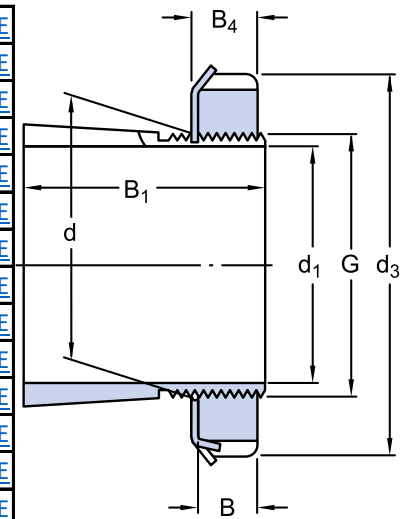

HE 3134 E	152.4	170	220	122	HE 3134 E	KMFE 34		HMT 34 E
HE 2334	152.4	170	220	154	HE 2334	KM 34	MB 34	HMT 34 E
HA 3036	163.513	180	210	109	HA 3036	KML 36	MBL 36	HMT 36 E
HA 3136 L	163.513	180	210	131	HA 3136 L	KML 36	MBL 36	HMT 36 E
HA 3036 E	163.513	180	230	122	HA 3036 E	KMFE 36		HMT 36 E
HA 3136	163.513	180	230	131	HA 3136	KM 36	MB 36	HMT 36 E
HA 2336	163.513	180	230	161	HA 2336	KM 36	MB 36	HMT 36 E
HE 3036	165.1	180	210	109	HE 3036	KML 36	MBL 36	HMT 36 E
HE 3036 E	165.1	180	230	122	HE 3036 E	KMFE 36		HMT 36 E
HE 3136	165.1	180	230	131	HE 3136	KM 36	MB 36	HMT 36 E
HE 2336	165.1	180	230	161	HE 2336	KM 36	MB 36	HMT 36 E
HE 3038	171.45	190	220	112	HE 3038	KML 38	MBL 38	HMT 38 E
HE 3138	171.45	190	240	141	HE 3138	KM 38	MB 38	HMT 38 E
HE 2338	171.45	190	240	169	HE 2338	KM 38	MB 38	HMT 38 E
HA 3038	176.213	190	220	112	HA 3038	KML 38	MBL 38	HMT 38 E
HA 3138	176.213	190	240	141	HA 3138	KM 38	MB 38	HMT 38 E
HA 2338	176.213	190	240	169	HA 2338	KM 38	MB 38	HMT 38 E
HE 3040	177.8	200	240	120	HE 3040	KML 40	MBL 40	HMT 40 E
HE 2340 L	177.8	200	240	176	HE 2340 L	KML 40	MBL 40	HMT 40 E
HE 3140	177.8	200	250	150	HE 3140	KM 40	MB 40	HMT 40 E
HA 3040	182.563	200	240	120	HA 3040	KML 40	MBL 40	HMT 40 E
HA 2340 L	182.563	200	240	176	HA 2340 L	KML 40	MBL 40	HMT 40 E
HA 3140	182.563	200	250	150	HA 3140	KM 40	MB 40	HMT 40 E
HA 2340	182.563	200	250	176	HA 2340	KM 40	MB 40	HMT 40 E

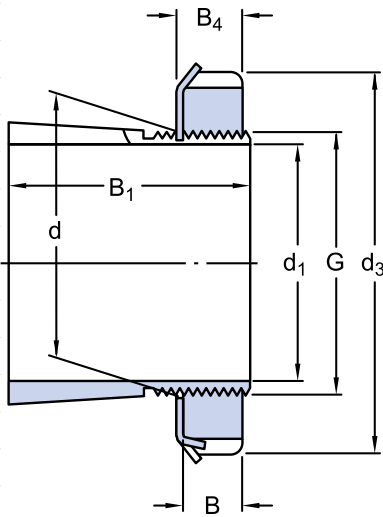

Designations	Principal dimensions				Designations				
Adapter sleeve assembly					Adapter sleeve assembly	Included sleeve	Included lock nut	Included locking device	Associated hydraulic nut
	d1[mm]	d[mm]	d3max.[mm]	B1[mm]					
SNW 5x3/4	19.05	25	39.827	31.979	SNW 5x3/4	S 5x3/4	N 05	W 05	
SNW 6x15/16	23.813	30	44.577	34.112	SNW 6x15/16	S 6x15/16	N 06	W 06	
SNW 7x1.1/8	28.575	35	52.527	36.805	SNW 7x1.1/8	S 7x1.1/8	N 07	W 07	
SNW 7x1.3/16	30.163	35	52.527	36.805	SNW 7x1.3/16	S 7x1.3/16	N 07	W 07	
SNW 7x1.1/4	31.75	35	52.527	36.805	SNW 7x1.1/4	S 7x1.1/4	N 07	W 07	
SNW 8x1.1/4	31.75	40	57.277	37.948	SNW 8x1.1/4	S 8x1.1/4	N 08	W 08	
SNW 8x1.5/16	33.338	40	57.277	37.948	SNW 8x1.5/16	S 8x1.5/16	N 08	W 08	
SNW 9x1.5/16	33.338	45	64.414	39.98	SNW 9x1.5/16	S 9x1.5/16	N 09	W 09	
SNW 8x1.3/8	34.925	40	57.277	37.948	SNW 8x1.3/8	S 8x1.3/8	N 08	W 08	
SNW 9x1.3/8	34.925	45	64.414	39.98	SNW 9x1.3/8	S 9x1.3/8	N 09	W 09	
SNW 9x1.7/16	36.513	45	64.414	39.98	SNW 9x1.7/16	S 9x1.7/16	N 09	W 09	
SNW 109x1.7/16	36.513	45	64.414	53.924	SNW 109x1.7/16	S 109x1.7/16	N 09	W 09	
SNW 9x1.1/2	38.1	45	64.414	39.98	SNW 9x1.1/2	S 9x1.1/2	N 09	W 09	
SNW 109x1.1/2	38.1	45	64.414	53.924	SNW 109x1.1/2	S 109x1.1/2	N 09	W 09	
SNW 10x1.5/8	41.275	50	68.402	44.577	SNW 10x1.5/8	S 10x1.5/8	N 10	W 10	HMVC 10E
SNW 10x1.11/16	42.863	50	68.402	44.577	SNW 10x1.11/16	S 10x1.11/16	N 10	W 10	HMVC 10E
SNW 110x1.11/16	42.863	50	68.402	60.554	SNW 110x1.11/16	S 110x1.11/16	N 10	W 10	HMVC 10E
SNW 10x1.3/4	44.45	50	68.402	44.577	SNW 10x1.3/4	S 10x1.3/4	N 10	W 10	HMVC 10E
SNW 110x1.3/4	44.45	55	68.402	60.554	SNW 110x1.3/4	S 110x1.3/4	N 10	W 10	HMVC 10E
SNW 11x1.3/4	44.45	55	75.54	46.609	SNW 11x1.3/4	S 11x1.3/4	N 11	W 11	HMVC 11E
SNW 11x1.13/16	46.038	55	75.54	46.609	SNW 11x1.13/16	S 11x1.13/16	N 11	W 11	HMVC 11E
SNW 11x1.7/8	47.625	55	75.54	46.609	SNW 11x1.7/8	S 11x1.7/8	N 11	W 11	HMVC 11E
SNW 111x1.7/8	47.625	55	75.54	63.652	SNW 111x1.7/8	S 111x1.7/8	N 11	W 11	HMVC 11E
SNW 11x1.15/16	49.213	55	75.54	46.609	SNW 11x1.15/16	S 11x1.15/16	N 11	W 11	HMVC 11E
SNW 111x1.15/16	49.213	55	75.54	63.652	SNW 111x1.15/16	S 111x1.15/16	N 11	W 11	HMVC 11E
SNW 112x2.1/16	52.388	60	80.289	67.285	SNW 112x2.1/16	S 112x2.1/16	N 12	W 12	HMVC 12E
SNW 13x2.1/8	53.975	65	85.852	53.086	SNW 13x2.1/8	S 13x2.1/8	N 13	W 13	HMVC 13E
SNW 13x2.3/16	55.563	65	85.852	53.086	SNW 13x2.3/16	S 13x2.3/16	N 13	W 13	HMVC 13E
SNW 113x2.3/16	55.563	65	85.852	70.129	SNW 113x2.3/16	S 113x2.3/16	N 13	W 13	HMVC 13E
SNW 13x2.1/4	57.15	65	85.852	53.086	SNW 13x2.1/4	S 13x2.1/4	N 13	W 13	HMVC 13E
SNW 113x2.1/4	57.15	65	85.852	70.129	SNW 113x2.1/4	S 113x2.1/4	N 13	W 13	HMVC 13E
SNW 13x2.5/16	58.738	65	85.852	53.086	SNW 13x2.5/16	S 13x2.5/16	N 13	W 13	HMVC 13E
SNW 15x2.3/8	60.325	75	98.552	58.064	SNW 15x2.3/8	S 15x2.3/8	AN 15	W 15	HMVC 15E
SNW 15x2.7/16	61.913	75	98.552	58.064	SNW 15x2.7/16	S 15x2.7/16	AN 15	W 15	HMVC 15E
SNW 115x2.7/16	61.913	75	98.552	78.08	SNW 115x2.7/16	S 115x2.7/16	AN 15	W 15	HMVC 15E

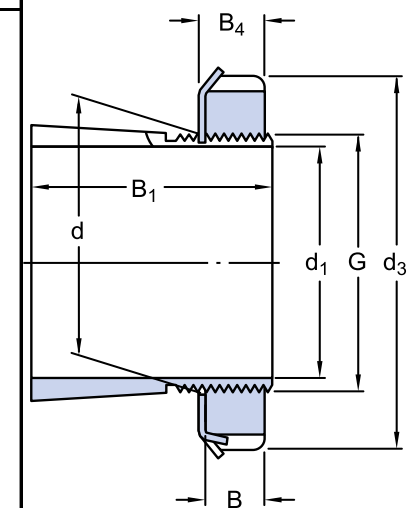

SNW 15x2.1/2	63.5	75	98.552	58.064	SNW 15x2.1/2	S 15x2.1/2	AN 15	W 15	HMVC 15E
SNW 115x2.1/2	63.5	75	98.552	78.08	SNW 115x2.1/2	S 115x2.1/2	AN 15	W 15	HMVC 15E
SNW 16x2.5/8	66.675	80	105.689	60.096	SNW 16x2.5/8	S 16x2.5/8	AN 16	W 16	HMVC 16E
SNW 16x2.11/16	68.263	80	105.689	60.096	SNW 16x2.11/16	S 16x2.11/16	AN 16	W 16	HMVC 16E
SNW 116x2.11/16	68.263	80	105.689	81.128	SNW 116x2.11/16	S 116x2.11/16	AN 16	W 16	HMVC 16E
SNW 16x2.3/4	69.85	80	105.689	60.096	SNW 16x2.3/4	S 16x2.3/4	AN 16	W 16	HMVC 16E
SNW 116x2.3/4	69.85	80	105.689	81.128	SNW 116x2.3/4	S 116x2.3/4	AN 16	W 16	HMVC 16E
SNW 17x2.13/16	71.438	85	112.039	62.89	SNW 17x2.13/16	S 17x2.13/16	AN 17	W 17	HMVC 17E
SNW 17x2.7/8	73.025	85	112.039	62.89	SNW 17x2.7/8	S 17x2.7/8	AN 17	W 17	HMVC 17E
SNW 17x2.15/16	74.613	85	112.039	62.89	SNW 17x2.15/16	S 17x2.15/16	AN 17	W 17	HMVC 17E
SNW 117x2.15/16	74.613	85	112.039	83.871	SNW 117x2.15/16	S 117x2.15/16	AN 17	W 17	HMVC 17E
SNW 17x3	76.2	85	112.039	62.89	SNW 17x3	S 17x3	AN 17	W 17	HMVC 17E
SNW 18x3.1/8	79.375	90	118.389	66.954	SNW 18x3.1/8	S 18x3.1/8	AN 18	W 18	HMVC 18E
SNW 18x3.3/16	80.963	90	118.389	66.954	SNW 18x3.3/16	S 18x3.3/16	AN 18	W 18	HMVC 18E
SNW 118x3.3/16	80.963	90	118.389	89.992	SNW 118x3.3/16	S 118x3.3/16	AN 18	W 18	HMVC 18E
SNW 18x3.1/4	82.55	90	118.389	66.954	SNW 18x3.1/4	S 18x3.1/4	AN 18	W 18	HMVC 18E
SNW 118x3.1/4	82.55	90	118.389	89.992	SNW 118x3.1/4	S 118x3.1/4	AN 18	W 18	HMVC 18E
SNW 19x3.5/16	84.138	95	125.552	69.85	SNW 19x3.5/16	S 19x3.5/16	AN 19	W 19	HMVC 19E
SNW 119x3.5/16	84.138	95	125.552	93.777	SNW 119x3.5/16	S 119x3.5/16	AN 19	W 19	HMVC 19E
SNW 20x3.3/8	85.725	100	131.902	72.619	SNW 20x3.3/8	S 20x3.3/8	AN 20	W 20	HMVC 20E
SNW 120x3.3/8	85.725	100	131.902	100.609	SNW 120x3.3/8	S 120x3.3/8	AN 20	W 20	HMVC 20E
SNW 20x3.7/16	87.313	100	131.902	72.619	SNW 20x3.7/16	S 20x3.7/16	AN 20	W 20	HMVC 20E
SNW 120x3.7/16	87.313	100	131.902	100.609	SNW 120x3.7/16	S 120x3.7/16	AN 20	W 20	HMVC 20E
SNW 20x3.1/2	88.9	100	131.902	72.619	SNW 20x3.1/2	S 20x3.1/2	AN 20	W 20	HMVC 20E
SNW 120x3.1/2	88.9	100	131.902	100.609	SNW 120x3.1/2	S 120x3.1/2	AN 20	W 20	HMVC 20E
SNW 21x3.11/16	93.663	105	138.252	75.616	SNW 21x3.11/16	S 21x3.11/16	AN 21	W 21	HMVC 21E
SNW 22x3.11/16	93.663	110	145.39	81.178	SNW 22x3.11/16	S 22x3.11/16	AN 22	W 22	HMVC 22E
SNW 122x3.11/16	93.663	110	145.39	110.185	SNW 122x3.11/16	S 122x3.11/16	AN 22	W 22	HMVC 22E
SNW 122x3.3/4	95.25	110	145.39	110.185	SNW 122x3.3/4	S 122x3.3/4	AN 22	W 22	HMVC 22E
SNW 22x3.13/16	96.838	110	145.39	81.178	SNW 22x3.13/16	S 22x3.13/16	AN 22	W 22	HMVC 22E
SNW 122x3.13/16	96.838	110	145.39	110.185	SNW 122x3.13/16	S 122x3.13/16	AN 22	W 22	HMVC 22E
SNW 22x3.7/8	98.425	110	145.39	81.178	SNW 22x3.7/8	S 22x3.7/8	AN 22	W 22	HMVC 22E
SNW 22x3.15/16	100.013	110	145.39	81.178	SNW 22x3.15/16	S 22x3.15/16	AN 22	W 22	HMVC 22E
SNW 122x3.15/16	100.013	110	145.39	110.185	SNW 122x3.15/16	S 122x3.15/16	AN 22	W 22	HMVC 22E
SNW 3024x4.3/16	106.363	120	144.602	74.6	SNW 3024x4.3/16	S 3024x4.3/16	N 024	W 024	HMVC 24E
SNW 3124x4.3/16	106.363	120	144.602	87.782	SNW 3124x4.3/16	S 24x4.3/16	N 024	W 024	HMVC 24E
SNW 24x4.3/16	106.363	120	155.702	87.782	SNW 24x4.3/16	S 24x4.3/16	AN 24	W 24	HMVC 24E
SNW 124x4.3/16	106.363	120	155.702	117.805	SNW 124x4.3/16	S 124x4.3/16	AN 24	W 24	HMVC 24E
SNW 3024x4.1/4	107.95	120	144.602	74.6	SNW 3024x4.1/4	S 3024x4.1/4	N 024	W 024	HMVC 24E
SNW 24x4.1/4	107.95	120	155.702	87.782	SNW 24x4.1/4	S 24x4.1/4	AN 24	W 24	HMVC 24E
SNW 26x4.5/16	109.538	130	171.577	95.301	SNW 26x4.5/16	S 26x4.5/16	AN 26	W 26	HMVC 26E
SNW 26x4.3/8	111.125	130	171.577	95.301	SNW 26x4.3/8	S 26x4.3/8	AN 26	W 26	HMVC 26E
SNW 3026x4.7/16	112.713	130	155.702	81.966	SNW 3026x4.7/16	S 3026x4.7/16	N 026	W 026	HMVC 26E
SNW 3126x4.7/16	112.713	130	155.702	95.301	SNW 3126x4.7/16	S 26x4.7/16	N 026	W 026	HMVC 26E
SNW 26x4.7/16	112.713	130	171.577	95.301	SNW 26x4.7/16	S 26x4.7/16	AN 26	W 26	HMVC 26E
SNW 126x4.7/16	112.713	130	171.577	126.289	SNW 126x4.7/16	S 126x4.7/16	AN 26	W 26	HMVC 26E
SNW 3026x4.1/2	114.3	130	155.702	81.966	SNW 3026x4.1/2	S 3026x4.1/2	N 026	W 026	HMVC 26E
SNW 3126x4.1/2	114.3	130	155.702	95.301	SNW 3126x4.1/2	S 26x4.1/2	N 026	W 026	HMVC 26E
SNW 26x4.1/2	114.3	130	171.577	95.301	SNW 26x4.1/2	S 26x4.1/2	AN 26	W 26	HMVC 26E
SNW 126x4.1/2	114.3	130	171.577	126.289	SNW 126x4.1/2	S 126x4.1/2	AN 26	W 26	HMVC 26E
SNW 3028x4.13/16	122.238	140	165.227	84.582	SNW 3028x4.13/16	S 3028x4.13/16	N 028	W 028	HMVC 28E
SNW 28x4.7/8	123.825	140	180.315	100.863	SNW 28x4.7/8	S 28x4.7/8	AN 28	W 28	HMVC 28E

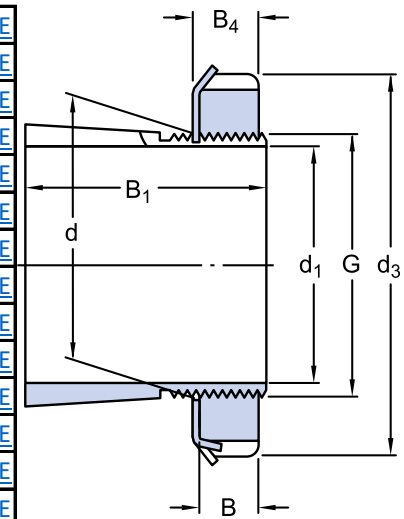

SNW 128x4.7/8	123.825	140	180.315	134.95	SNW 128x4.7/8	S 128x4.7/8	AN 28	W 28	HMVC 28E
SNW 3028x4.15/16	125.413	140	165.227	84.582	SNW 3028x4.15/16	S 3028x4.15/16	N 028	W 028	HMVC 28E
SNW 3128x4.15/16	125.413	140	165.227	100.863	SNW 3128x4.15/16	S 28x4.15/16	N 028	W 028	HMVC 28E
SNW 28x4.15/16	125.413	140	180.315	100.863	SNW 28x4.15/16	S 28x4.15/16	AN 28	W 28	HMVC 28E
SNW 128x4.15/16	125.413	140	180.315	134.95	SNW 128x4.15/16	S 128x4.15/16	AN 28	W 28	HMVC 28E
SNW 130x5.1/8	130.175	150	195.402	142.519	SNW 130x5.1/8	S 130x5.1/8	AN 30	W 30	HMVC 30E
SNW 3030x5.3/16	131.763	150	181.102	88.443	SNW 3030x5.3/16	S 3030x5.3/16	N 030	W 030	HMVC 30E
SNW 3130x5.3/16	131.763	150	181.102	107.467	SNW 3130x5.3/16	S 30x5.3/16	N 030	W 030	HMVC 30E
SNW 30x5.3/16	131.763	150	195.402	107.467	SNW 30x5.3/16	S 30x5.3/16	AN 30	W 30	HMVC 30E
SNW 130x5.3/16	131.763	150	195.402	142.519	SNW 130x5.3/16	S 130x5.3/16	AN 30	W 30	HMVC 30E
SNW 30x5.1/4	133.35	150	195.402	107.467	SNW 30x5.1/4	S 30x5.1/4	AN 30	W 30	HMVC 30E
SNW 3032x5.3/8	136.525	160	190.627	94.005	SNW 3032x5.3/8	S 3032x5.3/8	N 032	W 032	HMVC 32E
SNW 32x5.3/8	136.525	160	204.927	116.027	SNW 32x5.3/8	S 32x5.3/8	AN 32	W 32	HMVC 32E
SNW 3032x5.7/16	138.113	160	190.627	94.005	SNW 3032x5.7/16	S 3032x5.7/16	N 032	W 032	HMVC 32E
SNW 3132x5.7/16	138.113	160	190.627	116.027	SNW 3132x5.7/16	S 32x5.7/16	N 032	W 032	HMVC 32E
SNW 32x5.7/16	138.113	160	204.927	116.027	SNW 32x5.7/16	S 32x5.7/16	AN 32	W 32	HMVC 32E
SNW 132x5.7/16	138.113	160	204.927	150.114	SNW 132x5.7/16	S 132x5.7/16	AN 32	W 32	HMVC 32E
SNW 3032x5.1/2	139.7	160	190.627	94.005	SNW 3032x5.1/2	S 3032x5.1/2	N 032	W 032	HMVC 32E
SNW 32x5.1/2	139.7	160	204.927	116.027	SNW 32x5.1/2	S 32x5.1/2	AN 32	W 32	HMVC 32E
SNW 32x5.3/4	146.05	160	204.927	116.027	SNW 32x5.3/4	S 32x5.3/4	AN 32	W 32	HMVC 32E
SNW 34x5.13/16	147.638	170	219.989	122.86	SNW 34x5.13/16	S 34x5.13/16	AN 34	W 34	HMVC 34E
SNW 134x5.13/16	147.638	170	219.989	156.921	SNW 134x5.13/16	S 134x5.13/16	AN 34	W 34	HMVC 34E
SNW 3034x5.7/8	149.225	170	200.152	101.829	SNW 3034x5.7/8	S 3034x5.7/8	N 034	W 034	HMVC 34E
SNW 34x5.7/8	149.225	170	219.989	122.86	SNW 34x5.7/8	S 34x5.7/8	AN 34	W 34	HMVC 34E
SNW 3034x5.15/16	150.813	170	200.152	101.829	SNW 3034x5.15/16	S 3034x5.15/16	N 034	W 034	HMVC 34E
SNW 3134x5.15/16	150.813	170	200.152	122.86	SNW 3134x5.15/16	S 34x5.15/16	N 034	W 034	HMVC 34E
SNW 34x5.15/16	150.813	170	219.989	122.86	SNW 34x5.15/16	S 34x5.15/16	AN 34	W 34	HMVC 34E
SNW 134x5.15/16	150.813	170	219.989	156.921	SNW 134x5.15/16	S 134x5.15/16	AN 34	W 34	HMVC 34E
SNW 36x6.5/16	160.338	180	230.327	127.711	SNW 36x6.5/16	S 36x6.5/16	AN 36	W 36	HMVC 36E
SNW 3036x6.7/16	163.513	180	209.677	109.906	SNW 3036x6.7/16	S 3036x6.7/16	N 036	W 036	HMVC 36E
SNW 3136x6.7/16	163.513	180	209.677	127.711	SNW 3136x6.7/16	S 36x6.7/16	N 036	W 036	HMVC 36E
SNW 36x6.7/16	163.513	180	230.327	127.711	SNW 36x6.7/16	S 36x6.7/16	AN 36	W 36	HMVC 36E
SNW 136x6.7/16	163.513	180	230.327	163.728	SNW 136x6.7/16	S 136x6.7/16	AN 36	W 36	HMVC 36E
SNW 3036x6.1/2	165.1	180	209.677	109.906	SNW 3036x6.1/2	S 3036x6.1/2	N 036	W 036	HMVC 36E
SNW 3136x6.1/2	165.1	180	209.677	127.711	SNW 3136x6.1/2	S 36x6.1/2	N 036	W 036	HMVC 36E
SNW 36x6.1/2	165.1	180	230.327	127.711	SNW 36x6.1/2	S 36x6.1/2	AN 36	W 36	HMVC 36E
SNW 38x6.7/8	174.625	190	240.64	133.375	SNW 38x6.7/8	S 38x6.7/8	AN 38	W 38	HMVC 38E
SNW 3038x6.15/16	176.213	190	220.802	111.811	SNW 3038x6.15/16	S 3038x6.15/16	N 038	W 038	HMVC 38E
SNW 3138x6.15/16	176.213	190	220.802	133.375	SNW 3138x6.15/16	S 38x6.15/16	N 038	W 038	HMVC 38E
SNW 38x6.15/16	176.213	190	240.64	133.375	SNW 38x6.15/16	S 38x6.15/16	AN 38	W 38	HMVC 38E
SNW 138x6.15/16	176.213	190	240.64	171.399	SNW 138x6.15/16	S 138x6.15/16	AN 38	W 38	HMVC 38E
SNW 138x7	177.8	190	240.64	171.399	SNW 138x7	S 138x7	AN 38	W 38	HMVC 38E
SNW 3040x7.1/8	180.975	200	239.852	120.396	SNW 3040x7.1/8	S 3040x7.1/8	N 040	W 040	HMVC 40E
SNW 3040x7.3/16	182.563	200	239.852	120.396	SNW 3040x7.3/16	S 3040x7.3/16	N 040	W 040	HMVC 40E
SNW 3140x7.3/16	182.563	200	239.852	139.04	SNW 3140x7.3/16	S 40x7.3/16	N 040	W 040	HMVC 40E
SNW 40x7.3/16	182.563	200	250.165	139.04	SNW 40x7.3/16	S 40x7.3/16	AN 40	W 40	HMVC 40E
SNW 140x7.3/16	182.563	200	250.165	179.959	SNW 140x7.3/16	S 140x7.3/16	AN 40	W 40	HMVC 40E
SNW 40x7.1/4	184.15	200	250.165	139.04	SNW 40x7.1/4	S 40x7.1/4	AN 40	W 40	HMVC 40E
SNW 44x7.1/2	190.5	220	279.527	149.631	SNW 44x7.1/2	S 44x7.1/2	N 44	W 44	HMVC 44E
SNW 3044x7.13/16	198.438	220	260.477	130.048	SNW 3044x7.13/16	S 3044x7.13/16	N 044	W 044	HMVC 44E
SNW 44x7.13/16	198.438	220	279.527	149.631	SNW 44x7.13/16	S 44x7.13/16	N 44	W 44	HMVC 44E
SNW 3044x7.7/8	200.025	220	260.477	130.048	SNW 3044x7.7/8	S 3044x7.7/8	N 044	W 044	HMVC 44E

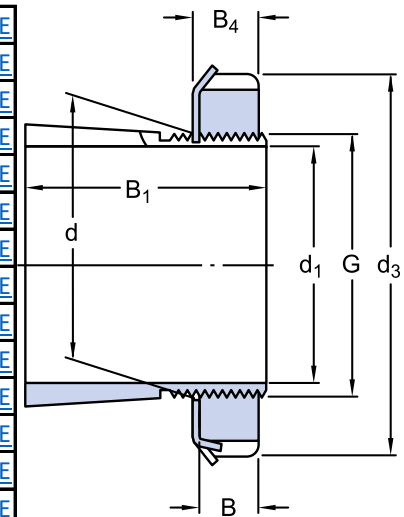

SNW 44x7.7/8	200.025	220	279.527	149.631	SNW 44x7.7/8	S 44x7.7/8	N 44	W 44	HMVC 44E
SNW 3044x7.15/16	201.613	220	260.477	130.048	SNW 3044x7.15/16	S 3044x7.15/16	N 044	W 044	HMVC 44E
SNW 3144x7.15/16	201.613	220	260.477	149.631	SNW 3144x7.15/16	S 44x7.15/16	N 044	W 044	HMVC 44E
SNW 44x7.15/16	201.613	220	279.527	149.631	SNW 44x7.15/16	S 44x7.15/16	N 44	W 44	HMVC 44E
SNW 144x7.15/16	201.613	220	279.527	184.836	SNW 144x7.15/16	S 144x7.15/16	N 44	W 44	HMVC 44E
SNW 144x8	203.2	220	279.527	183.566	SNW 144x8	S 144x8	N 44	W 44	HMVC 44E
SNP 3048x8.7/16	214.313	240	290.652	137.719	SNP 3048x8.7/16	S 3048x8.7/16	N 048	PL 48	HMVC 48E
SNP 3048x8.1/2	215.9	240	290.652	137.719	SNP 3048x8.1/2	S 3048x8.1/2	N 048	PL 48	HMVC 48E
SNP 3048x8.15/16	227.013	240	290.652	137.719	SNP 3048x8.15/16	S 3048x8.15/16	N 048	PL 48	HMVC 48E
SNP 3148x8.15/16	227.013	240	290.652	168.351	SNP 3148x8.15/16	S 48x8.15/16	N 048	PL 48	HMVC 48E
SNP 148x8.15/16	227.013	240	290.652	205.715	SNP 148x8.15/16	S 148x8.15/16	N 048	PL 48	HMVC 48E
SNP 3048x9	228.6	240	290.652	137.719	SNP 3048x9	S 3048x9	N 048	PL 48	HMVC 48E
SNP 3152x9	228.6	240	309.702	192.608	SNP 3152x9	S 52x9	N 052	PL 52	HMVC 52E
SNP 152x9	228.6	260	309.702	222.606	SNP 152x9	S 152x9	N 052	PL 52	HMVC 52E
SNP 3052x9.7/16	239.713	260	309.702	152.629	SNP 3052x9.7/16	S 3052x9.7/16	N 052	PL 52	HMVC 52E
SNP 3152x9.7/16	239.713	260	309.702	192.608	SNP 3152x9.7/16	S 52x9.7/16	N 052	PL 52	HMVC 52E
SNP 152x9.7/16	239.713	260	309.702	222.606	SNP 152x9.7/16	S 152x9.7/16	N 052	PL 52	HMVC 52E
SNP 3052x9.1/2	241.3	260	309.702	152.629	SNP 3052x9.1/2	S 3052x9.1/2	N 052	PL 52	HMVC 52E
SNP 3152x9.1/2	241.3	260	309.702	192.608	SNP 3152x9.1/2	S 52x9.1/2	N 052	PL 52	HMVC 52E
SNP 3056x9.15/16	252.413	280	330.327	156.997	SNP 3056x9.15/16	S 3056x9.15/16	N 056	PL 56	HMVC 56E
SNP 3056x10	254	280	330.327	156.997	SNP 3056x10	S 3056x10	N 056	PL 56	HMVC 56E
SNP 3156x10	254	280	330.327	197.002	SNP 3156x10	S 3156x10	N 056	PL 56	HMVC 56E
SNP 3056x10.7/16	265.113	280	330.327	156.997	SNP 3056x10.7/16	S 3056x10.7/16	N 056	PL 56	HMVC 56E
SNP 3156x10.7/16	265.113	280	330.327	197.002	SNP 3156x10.7/16	S 3156x10.7/16	N 056	PL 56	HMVC 56E
SNP 3256x10.7/16	265.113	280	330.327	227	SNP 3256x10.7/16	S 3256x10.7/16	N 056	PL 56	HMVC 56E
SNP 3056x10.1/2	266.7	280	330.327	156.997	SNP 3056x10.1/2	S 3056x10.1/2	N 056	PL 56	HMVC 56E
SNP 3156x10.1/2	266.7	280	330.327	197.002	SNP 3156x10.1/2	S 3156x10.1/2	N 056	PL 56	HMVC 56E
SNP 3060x10.15/16	277.813	300	360.502	170.612	SNP 3060x10.15/16	S 3060x10.15/16	N 060	PL 60	HMVC 60E
SNP 3160x10.15/16	277.813	300	360.502	212.598	SNP 3160x10.15/16	S 3160x10.15/16	N 060	PL 60	HMVC 60E
SNP 3260x10.15/16	277.813	300	360.502	244.602	SNP 3260x10.15/16	S 3260x10.15/16	N 060	PL 60	HMVC 60E
SNP 3060x11	279.4	300	360.502	170.612	SNP 3060x11	S 3060x11	N 060	PL 60	HMVC 60E
SNP 3260x11	279.4	300	360.502	244.602	SNP 3260x11	S 3260x11	N 060	PL 60	HMVC 60E
SNP 3064x11.7/16	290.513	320	381.127	176.174	SNP 3064x11.7/16	S 3064x11.7/16	N 064	PL 64	HMVC 64E
SNP 3064x11.1/2	292.1	320	381.127	176.174	SNP 3064x11.1/2	S 3064x11.1/2	N 064	PL 64	HMVC 64E
SNP 3064x11.15/16	303.213	320	381.127	176.174	SNP 3064x11.15/16	S 3064x11.15/16	N 064	PL 64	HMVC 64E
SNP 3164x11.15/16	303.213	320	381.127	231.165	SNP 3164x11.15/16	S 3164x11.15/16	N 064	PL 64	HMVC 64E
SNP 3064x12	304.8	320	381.127	176.174	SNP 3064x12	S 3064x12	N 064	PL 64	HMVC 64E
SNP 3164x12	304.8	320	381.127	231.165	SNP 3164x12	S 3164x12	N 064	PL 64	HMVC 64E
SNP 3264x12	304.8	320	381.127	263.169	SNP 3264x12	S 3264x12	N 064	PL 64	HMVC 64E
SNP 3068x12.7/16	315.913	340	400.177	191.338	SNP 3068x12.7/16	S 3068x12.7/16	N 068	PL 68	HMVC 68E
SNP 3168x12.7/16	315.913	340	400.177	248.336	SNP 3168x12.7/16	S 3168x12.7/16	N 068	PL 68	HMVC 68E
SNP 3268x12.7/16	315.913	340	400.177	282.346	SNP 3268x12.7/16	S 3268x12.7/16	N 068	PL 68	HMVC 68E
SNP 3072x13.7/16	341.313	360	419.227	192.253	SNP 3072x13.7/16	S 3072x13.7/16	N 072	PL 72	HMVC 72E
SNP 3172x13.7/16	341.313	360	419.227	250.241	SNP 3172x13.7/16	S 3172x13.7/16	N 072	PL 72	HMVC 72E
SNP 3272x13.7/16	341.313	360	419.227	290.246	SNP 3272x13.7/16	S 3272x13.7/16	N 072	PL 72	HMVC 72E
SNP 3276x13.15/16	354.013	360	450.977	301.422	SNP 3276x13.15/16	S 3276x13.15/16	N 076	PL 76	HMVC 76E
SNP 3076x13.15/16	354.013	380	450.977	196.418	SNP 3076x13.15/16	S 3076x13.15/16	N 076	PL 76	HMVC 76E
SNP 3176x13.15/16	354.013	380	450.977	255.422	SNP 3176x13.15/16	S 3176x13.15/16	N 076	PL 76	HMVC 76E
SNP 3276x14	355.6	360	450.977	301.422	SNP 3276x14	S 3276x14	N 076	PL 76	HMVC 76E
SNP 3076x14	355.6	380	450.977	196.418	SNP 3076x14	S 3076x14	N 076	PL 76	HMVC 76E
SNP 3180x14.15/16	379.413	400	470.027	265.405	SNP 3180x14.15/16	S 3180x14.15/16	N 080	PL 80	HMVC 80E
SNP 3080x15	381	400	470.027	213.385	SNP 3080x15	S 3080x15	N 080	PL 80	HMVC 80E

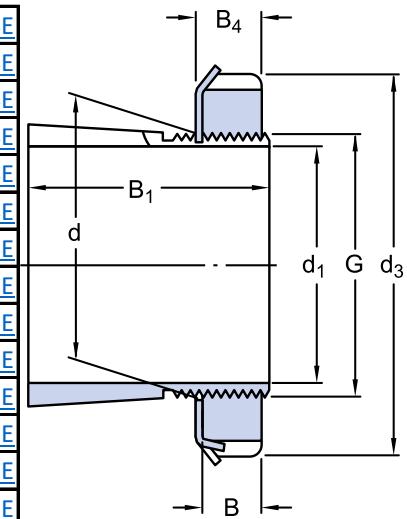

SNP 3180x15	381	400	470.027	265.405	SNP 3180x15	S 3180x15	N 080	PL 80	HMVC 80E
SNP 3280x15	381	400	470.027	321.412	SNP 3280x15	S 3280x15	N 080	PL 80	HMVC 80E
SNP 3084x15.3/4	400.05	420	490.677	215.595	SNP 3084x15.3/4	S 3084x15.3/4	N 084	PL 84	HMVC 84E
SNP 3184x15.3/4	400.05	420	490.677	289.611	SNP 3184x15.3/4	S 3184x15.3/4	N 084	PL 84	HMVC 84E
SNP 3284x15.3/4	400.05	420	490.677	337.617	SNP 3284x15.3/4	S 3284x15.3/4	N 084	PL 84	HMVC 84E
SNP 3088x16.1/2	419.1	440	520.827	231.14	SNP 3088x16.1/2	S 3088x16.1/2	N 088	PL 88	HMVC 88E
SNP 3188x16.1/2	419.1	440	520.827	300.152	SNP 3188x16.1/2	S 3188x16.1/2	N 088	PL 88	HMVC 88E
SNP 3096x18	457.2	480	560.527	239.928	SNP 3096x18	S 3096x18	N 096	PL 96	HMVC 96E
SNP 3196x18	457.2	480	560.527	322.936	SNP 3196x18	S 3196x18	N 096	PL 96	HMVC 96E

