

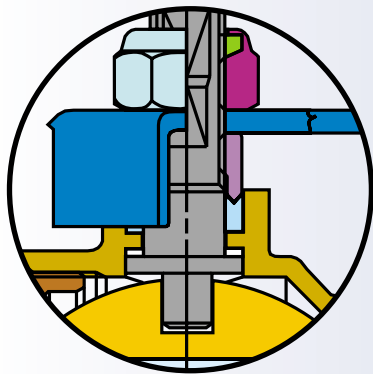

# LOGIC

## HEAVY LINE FULL BORE BALL VALVE

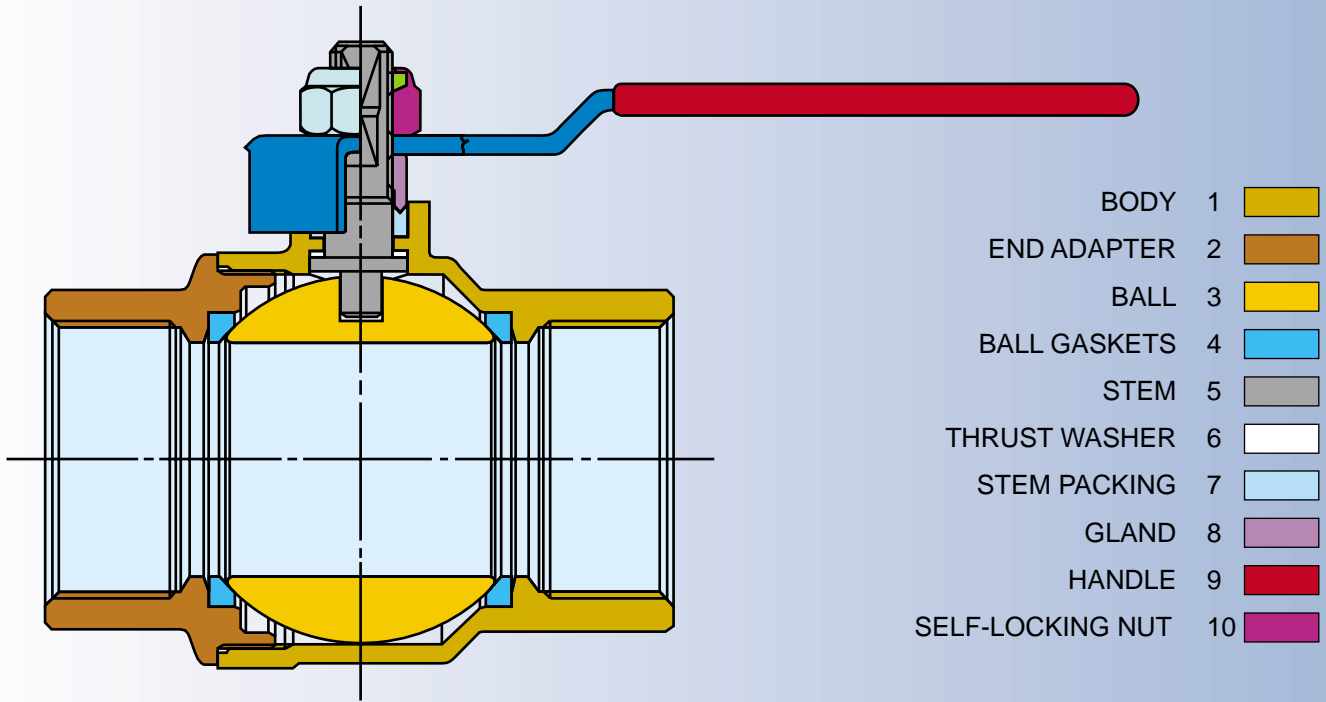

### DOUBLE SEAL BLOW OUT PROOF-STEM

- The **LOGIC** ball valves are bottom loaded stem designed. This "anti-blow-out" stem also prevents from tampering with the internals of the valve when in the line.
- The double seal is performed by an anti-friction teflon thrust washer, working as a high pressure gasket.





### FEATURES

- Heavy line, full bore, long threads.
- Perfect seal at low and high pressure.
- Wear resistant, solid and long lasting materials.
- Rapid on/off 90° turn operation.
- Easy visual control of open/closed position.

### END CONNECTIONS

- Screwed to ISO 7/1 Rp parallel standard.
- Screwed to ISO 7/1 Rc taper standard, available only upon request. The delivery time is to be agreed with the manufacturer everytime.

### UTILISATION

- The **LOGIC** ball valves are suitable for hot and cold water, compressed air, oils, non-corrosive fluids and hydrocarbons in general.
- For special uses, see the table of chemical resistance on pages 206 and 207.

### WORKING PRESSURE

- From PN 64 (size 1/4") to PN 16 (size 4").
- See pressure/temperature diagram.

### TEMPERATURE LIMITS

- -20°C +130°C

### PRESSURE/TEMPERATURE DIAGRAM

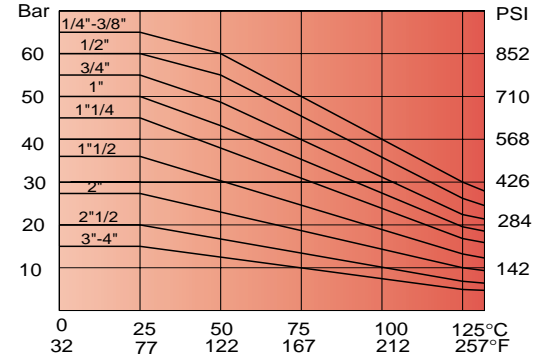

### LOSS OF HEAD DIAGRAM

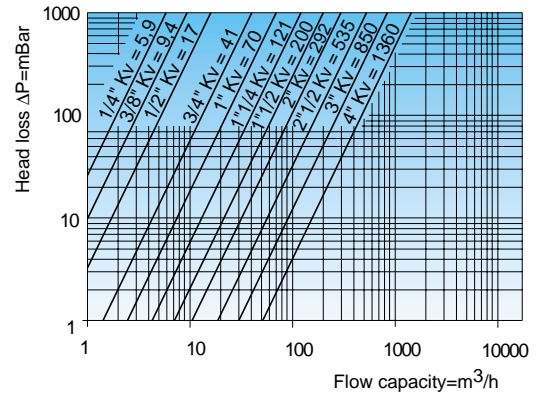

## MATERIAL SPECIFICATION

ITEM	MATERIAL	DESCRIPTION
■ 1 Body	CW 617 N UNI EN 12165	Nickel-plated forged brass
■ 2 End adapter	CW 617 N UNI EN 12165	Nickel-plated forged brass
■ 3 Ball	CW 614 N UNI EN 12164	Machined brass bar, chrome-plated
■ 4 Ball gaskets	P.T.F.E.	Pure Teflon
■ 5 Stem	CW 614 N UNI EN 12164	Machined brass bar, nickel-plated
□ 6 Thrust washer	P.T.F.E.	Pure Teflon
■ 7 Stem packing	P.T.F.E.	Pure Teflon
■ 8 Gland	CW 614 N UNI EN 12164	Machined brass bar
■ 9 Handle	Steel Fe P02	Zinc-plated, red P.V.C. insulated
■ 10 Self-locking nut	8G Steel	Zinc-plated steel
	Lever and T-handle	Red polyurethan-coated aluminium



Art. S.0194 LOGIC

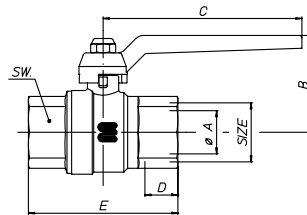
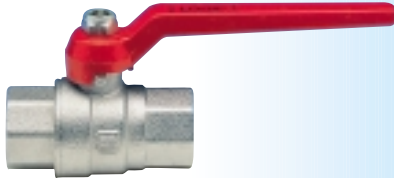

Full bore ball valve with aluminium lever, female/female, **heavy line**, nickel-plated.

SIZE	¼"	⅜"	½"	¾"	1"	1¼"	1½"	2"	2½"	3"	4"
øA bore	10	10	15	20	25	32	40	50	65	80	100
B mm	39,5	39,5	41,5	51	55	64,5	75,5	87,5	108	119,5	142
C mm	80	80	95	115	115	130	150	170	170	235	235
D mm	11	11,4	15	16,3	19,1	21,4	21,4	25,7	30,2	33,3	39,3
E mm	47,5	49,5	65	73,5	86,5	101,5	111,5	132,5	158	181,5	219
SW mm	17	21	26	32	39	48	55	68	83	97	124
Weight gr.	122	135	250	380	612	1010	1579	2678	3484	5634	10640

Art. S.0454 LOGIC • XT

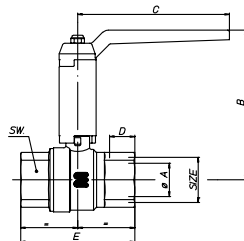
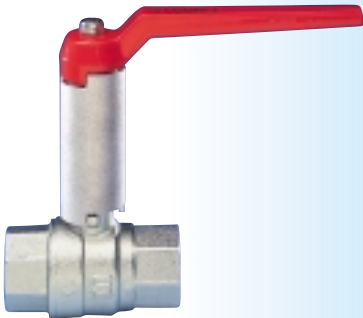

Full bore ball valve with extended stem, female/female, nickel-plated.

SIZE	¼"	⅜"	½"	¾"	1"	1¼"	1½"	2"	2½"	3"	4"
øA bore	10	10	15	20	25	32	40	50	65	80	100
B mm	96,5	96,5	98,5	109,5	113,5	123	133	145	164,5	176	197,5
C mm	80	80	95	115	115	130	150	170	170	235	235
D mm	11	11,4	15	16,3	19,1	21,4	21,4	25,7	30,2	33,3	39,3
E mm	47,5	49,5	65	73,5	86,5	101,5	111,5	132,5	158	181,5	219
SW mm	17	21	26	32	39	48	55	68	83	97	124
Weight gr.	203	216	326	484	713	1160	1747	2925	3723	6366	11562